

ALL DIMENSIONS ARE IN INCHES
UNLESS OTHERWISE STATED
TOLERANCES EXCEPT AS NOTED
DECIMALS:
.X ±0.100
.XX ±0.060
.XXX ±0.030
.XXXX ±0.010
ANGLES:
±1°
ALL FORMED ANGLES
EQUAL 90° UNLESS
NOTED OTHERWISE
() INDICATES REFERENCE

THE INFORMATION IN THIS DRAWING IS THE SOLE
PROPERTY OF KARAVAN TRAILERS, INC. ANY
REPRODUCTION IN PART OR WHOLE WITHOUT
THE WRITTEN PERMISSION OF KARAVAN TRAILERS,
INC. IS PROHIBITED.
APPROVED BY: ---
DRAWN BY: MJ HALFMANN
DATE: 11/12/2007
SHEET: 1 OF 7
SCALE: N/A

KARAVAN
TRAILERS

TITLE: KDP-1820-17/22-SPRING

MAT'L: SEE B.O.M.

FINISH: N/A

DWG. #: KDP-1820-17-22-SPRING

M	15457	LJW	01-31-12	UPDATED PRINT PER NEW STANDARD
L	15424	KMH	12-02-11	44.00" FENDER DIMENSION (E) WAS 62.00"
DWG. REV.	ECR/NDR NUMBER	REVISED BY	DATE	DESCRIPTION

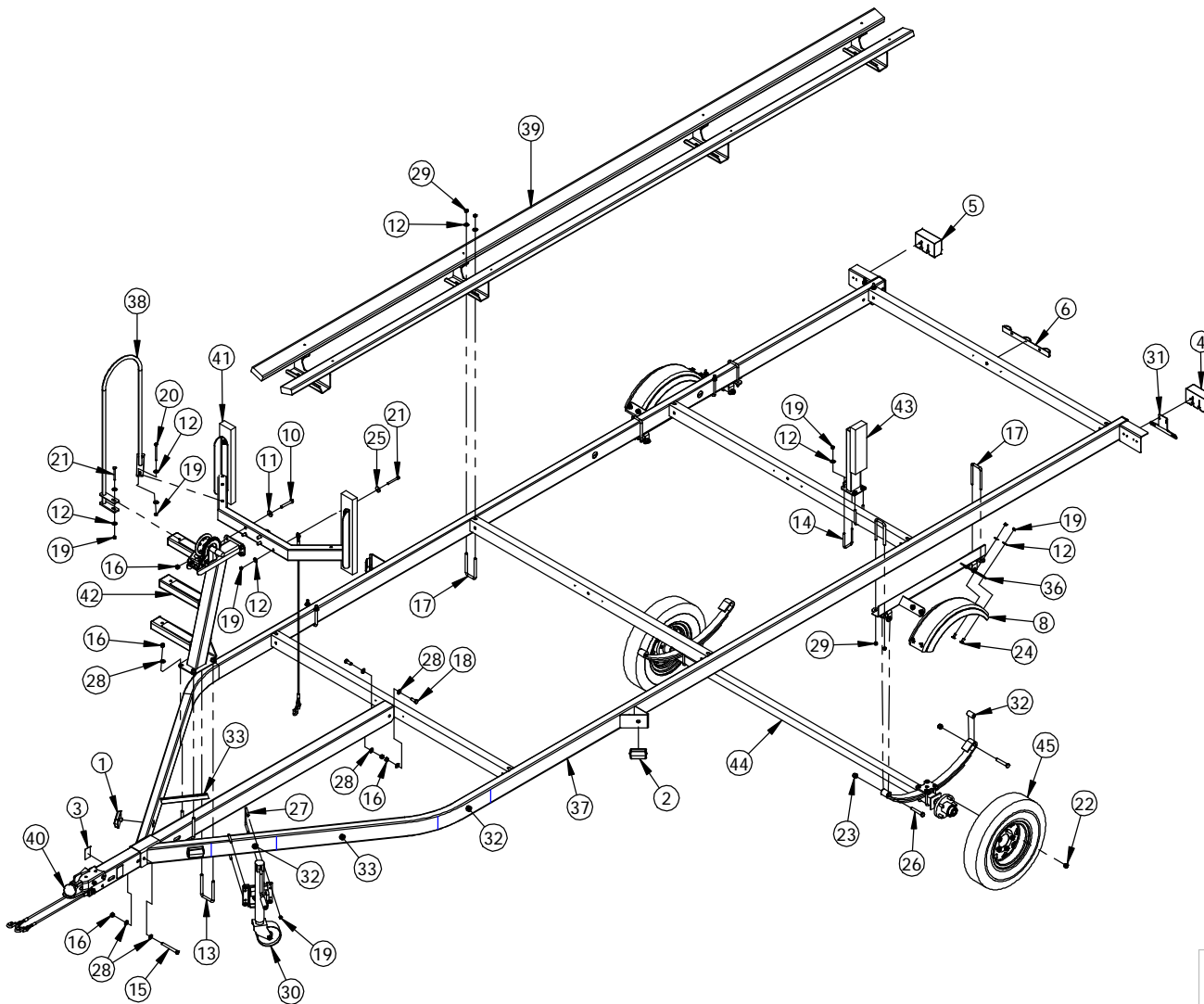

ITEM NO.	SEE NOTES	PART NUMBER	DESCRIPTION	QTY.
1		205-00105	AMBER SIDE LIGHT	2
2		205-00106	AMBER SIDE LIGHT	2
3		205-00142	AMBER REFLECTOR TAPE	2
4		205-00157	TAIL LIGHT LH.	1
5		205-00158	TAIL LIGHT R.H.	1
6		205-00163	I.D. BAR LIGHT SUBM.	1
7		205-00170	WIRE HARNESS	1
8		206-00039	FENDER	2
9		208-00046	SAFETY CABLE & HOOK	1
10		210-00012	.50"-13 X 3.00" HX HD BOLT	4
11		210-00017	.50" FLAT WASHER	4
12		210-00025	.375" FLAT WASHER	39
13		210-00030	.50"-13 X 3.063" X 5.25" U-BOLT	2
14		210-00031	.375"-16 X 2.031" X 3.75" U-BOLT	4
15		210-00040	.50"-13 X 4.50" HX HD BOLT	1
16		210-00061	.50"-13 CENTERLOCK HEX NUT	11
17		210-00068	.438"-14 X 2.25" X 5.31" U-BOLT	12
18		210-00072	.50"-13 X 1.25" HX HD BOLT	2
19		210-00076	.375"-16 CENTERLOCK HEX NUT	24
20		210-00080	.375"-16 X 4.00" HX HD BOLT	2
21		210-00089	.375"-16 X 3.00" HX HD BOLT	2
22		210-00137	.50"-20 X .813" LUG NUT	10
23		210-00157	.563"-12 NYLOCK HEX NUT	4
24		210-00194	.375"-16 X .875" CARRIAGE BOLT	8
25		210-00207	.375" FLAT WASHER	1
26		210-00211	.563"-12 X 3.25" HX HD BOLT	4
27		210-00231	.375"-16 X 3.00" X 4.06" U-BOLT	2
28		210-00240	.50" SAE FLAT WASHER ZINC	10
29		210-00330	.438"-14 CENTERLOCK HEX NUT	24
30	1	214-00008	TONGUE JACK	1
31		229-00006	LICENSE PLATE BRACKET	1
32		229-00095	BUSHING	2
33		234-00032	TRAILERING CHECKLIST	1
34		234-00058	LOGO	4
35		234-00060	LOGO	2
36	1	300-00953	SPRING HANGER	2
37		300-01609	FRAME WELDMENT	1
38		300-01673	HAND RAIL WELD	1
39	3	310-01885	BUNK ASSY	2
40	3	310-01891	TONGUE ASSY	1
41		310-02017	WINCH BOARD ASSY	1
42	1	310-02018	WINCH ASSY	1
43	3	310-02292	GUIDE-ON ASSY	2
44	1	AXLE ASSY	SEE OPTIONS	1
45	1	TIRE	5-HOLE TIRE & RIM	2

NOTES:

- 1.) SEE OPTIONS ON PAGE THREE.
- 2.) SEE ADDITIONAL INSTRUCTIONS ON PAGE FOUR.
- 3.) SEE ADDITIONAL INSTRUCTIONS ON PAGE SEVEN.

M	15457	LJW	01-31-12	UPDATED PRINT PER NEW STANDARD
L	15424	KMH	12-02-11	44.00" FENDER DIMENSION (E) WAS 62.00"
DWG. REV.	ECR/NDR NUMBER	REVISED BY	DATE	DESCRIPTION

ALL DIMENSIONS ARE IN INCHES UNLESS OTHERWISE STATED TOLERANCES EXCEPT AS NOTED
 DECIMALS:
 .X ±0.100
 .XX ±0.060
 .XXX ±0.030
 .XXXX ±0.010
 ANGLES:
 ±1°
 ALL FORMED ANGLES EQUAL 90° UNLESS NOTED OTHERWISE
 () INDICATES REFERENCE

THE INFORMATION IN THIS DRAWING IS THE SOLE PROPERTY OF KARAVAN TRAILERS, INC. ANY REPRODUCTION IN PART OR WHOLE WITHOUT THE WRITTEN PERMISSION OF KARAVAN TRAILERS, INC. IS PROHIBITED.
 APPROVED BY: ---
 DRAWN BY: MJ HALFMANN
 DATE: 11/12/2007
 SHEET: 2 OF 7
 SCALE: N/A

KARAVAN
TRAILERS

TITLE: KDP-1820-17/22-SPRING
 MAT'L: SEE B.O.M.
 FINISH: N/A
 DWG. #: KDP-1820-17-22-SPRING

HORIZONTAL GUIDE ON OPTION

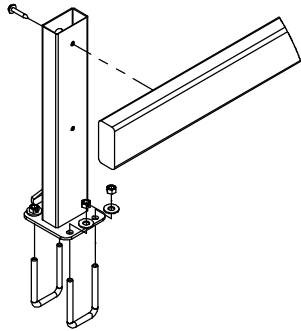

TONGUE TUBE OPTIONS

3" X 5" X 118"
3" X 5" X 142"

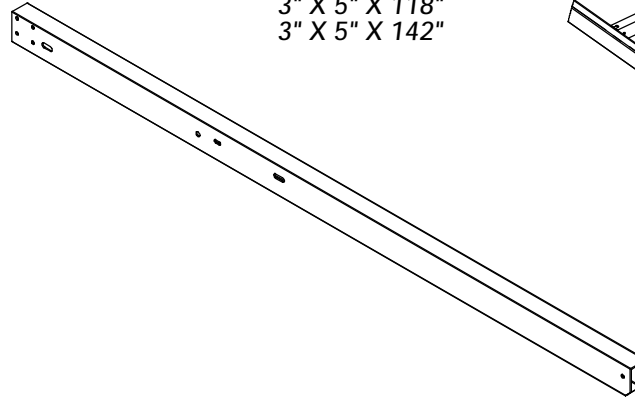

TRI-TOON KIT OPTION

2 X 4 CARPET
2 X 4 PLASTIC
2 X 6 CARPET
2 X 6 PLASTIC

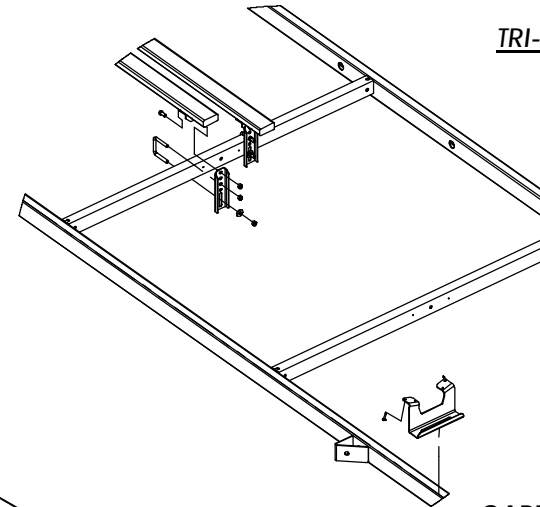

PLASTIC BUNK OPTIONS

2 X 4 X 192"
2 X 4 X 96" (TWO PER SIDE)
2 X 4 X 108" (TWO PER SIDE)
2 X 6 X 192"
2 X 6 X 96" (TWO PER SIDE)
2 X 6 X 108" (TWO PER SIDE)
2 X 6 X 120" (TWO PER SIDE)

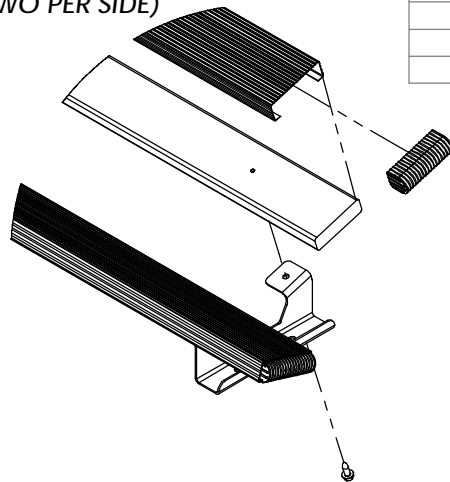

CARPET BUNK OPTIONS

2 X 4 X 96" (TWO PER SIDE)
2 X 4 X 108" (TWO PER SIDE)
2 X 6 X 192"
2 X 6 X 96" (TWO PER SIDE)
2 X 6 X 108" (TWO PER SIDE)
2 X 6 X 120" (TWO PER SIDE)

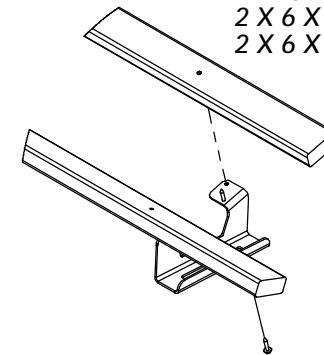

OPTIONS		
KDP-1820-17		KDP-1820-22
310-01894	AXLE ASSEMBLY	310-01899
220-00060	TIRE	220-00085

DWG. REV.	ECR/NDR NUMBER	REVISED BY	DATE	DESCRIPTION
M	15457	LJW	01-31-12	UPDATED PRINT PER NEW STANDARD
L	15424	KMH	12-02-11	44.00" FENDER DIMENSION (E) WAS 62.00"

ALL DIMENSIONS ARE IN INCHES
UNLESS OTHERWISE STATED
TOLERANCES EXCEPT AS NOTED
DECIMALS:
.X \$0.100
.XX \$0.060
.XXX \$0.030
.XXXX \$0.010
ANGLES:
±1°
ALL FORMED ANGLES
EQUAL 90° UNLESS
NOTED OTHERWISE
() INDICATES REFERENCE

THE INFORMATION IN THIS DRAWING IS THE SOLE
PROPERTY OF KARAVAN TRAILERS, INC. ANY
REPRODUCTION IN PART OR WHOLE WITHOUT
THE WRITTEN PERMISSION OF KARAVAN TRAILERS,
INC. IS PROHIBITED.
APPROVED BY: ---
DRAWN BY: MJ HALFMANN
DATE: 11/12/2007
SHEET: 3 OF 7
SCALE: N/A

KARAVAN
TRAILERS

TITLE: KDP-1820-17/22-SPRING
MAT'L: SEE B.O.M.
FINISH: N/A
DWG. #: KDP-1820-17-22-SPRING

THE TAIL LIGHT IS MOUNTED TO THE CENTER HOLES OF THE TAIL LIGHT BRACKET.

VIEW A

GREEN & WHITE WIRES RUN DOWN RIGHT SIDE TUBE.

YELLOW WIRE RUNS DOWN LEFT SIDE TUBE.

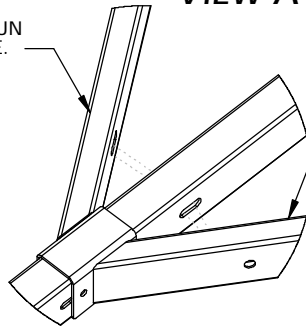

THE TAIL LIGHT IS MOUNTED TO THE CENTER HOLES OF THE TAIL LIGHT BRACKET.

VIEW B

ID BAR WIRE

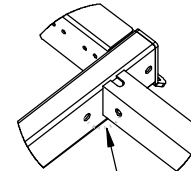

WIRE HARNESS

ALL DIMENSIONS ARE IN INCHES UNLESS OTHERWISE STATED TOLERANCES EXCEPT AS NOTED DECIMALS:
 .X ±0.100
 .XX ±0.060
 .XXX ±0.030
 .XXXX ±0.010
 ANGLES:
 ±1°
 ALL FORMED ANGLES EQUAL 90° UNLESS NOTED OTHERWISE
 () INDICATES REFERENCE

THE INFORMATION IN THIS DRAWING IS THE SOLE PROPERTY OF KARAVAN TRAILERS, INC. ANY REPRODUCTION IN PART OR WHOLE WITHOUT THE WRITTEN PERMISSION OF KARAVAN TRAILERS, INC. IS PROHIBITED.
 APPROVED BY: ---
 DRAWN BY: MJ/HALFMANN
 DATE: 11/12/2007
 SHEET: 4 OF 7
 SCALE: N/A

KARAVAN TRAILERS

TITLE: KDP-1820-17/22-SPRING

MAT'L: SEE B.O.M.

FINISH: N/A

DWG. #: KDP-1820-17-22-SPRING

M	15457	LJW	01-31-12	UPDATED PRINT PER NEW STANDARD
L	15424	KMH	12-02-11	44.00" FENDER DIMENSION (E) WAS 62.00"
DWG. REV.	ECR/NDR NUMBER	REVISED BY	DATE	DESCRIPTION

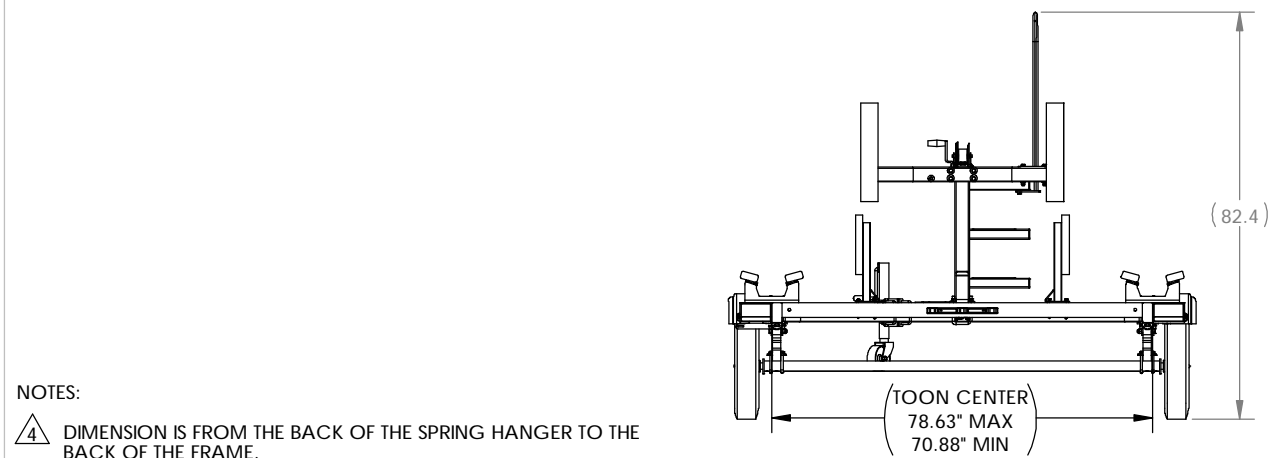
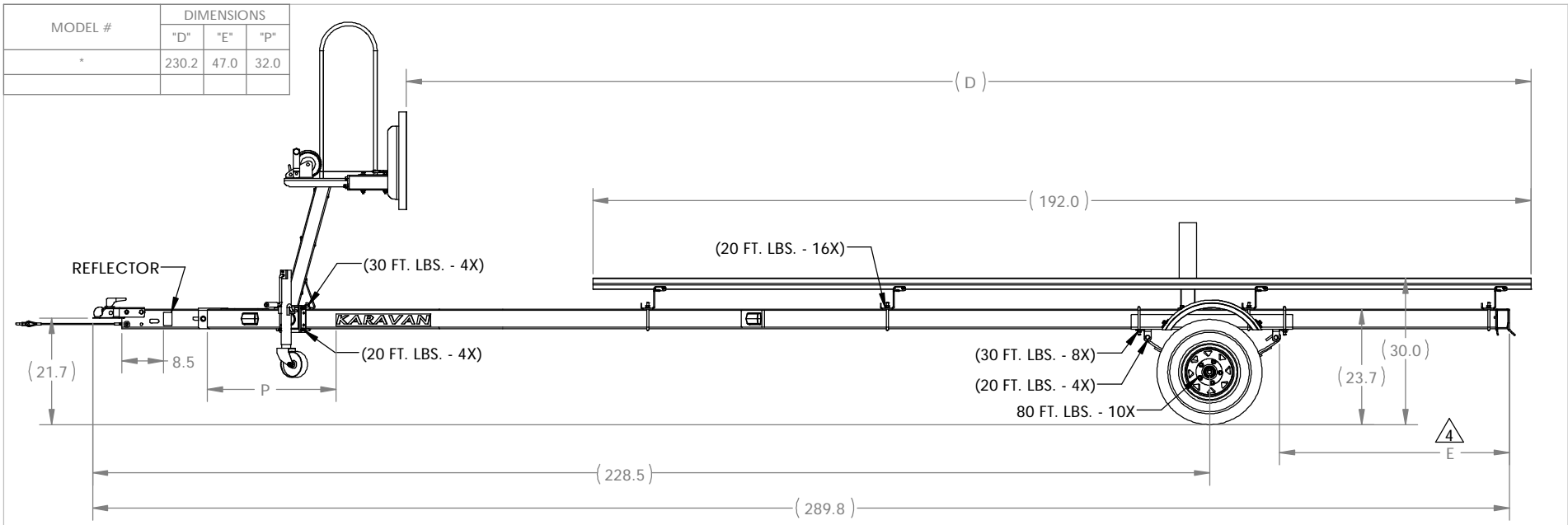

NOTES:
 4 DIMENSION IS FROM THE BACK OF THE SPRING HANGER TO THE BACK OF THE FRAME.

5.) TORQUE CALLOUTS IN PARENTHESIS ARE FOR REFERENCE. TIGHTEN FASTENERS UNTIL PINCHED TIGHT (DO NOT OVER TIGHTEN BUNK PIVOT POINTS). MINOR DEFLECTION OF MATERIAL IS ACCEPTABLE

DWG. REV.	ECR/NDR NUMBER	REVISED BY	DATE	DESCRIPTION
M	15457	LJW	01-31-12	UPDATED PRINT PER NEW STANDARD
L	15424	KMH	12-02-11	44.00" FENDER DIMENSION (E) WAS 62.00"

ALL DIMENSIONS ARE IN INCHES UNLESS OTHERWISE STATED TOLERANCES EXCEPT AS NOTED
 DECIMALS:
 .X ±0.100
 .XX ±0.060
 .XXX ±0.030
 .XXXX ±0.010
 ANGLES:
 ±1°
 ALL FORMED ANGLES EQUAL 90° UNLESS NOTED OTHERWISE
 () INDICATES REFERENCE

THE INFORMATION IN THIS DRAWING IS THE SOLE PROPERTY OF KARAVAN TRAILERS, INC. ANY REPRODUCTION IN PART OR WHOLE WITHOUT THE WRITTEN PERMISSION OF KARAVAN TRAILERS, INC. IS PROHIBITED.
 APPROVED BY: ---
 DRAWN BY: MJ HALFMANN
 DATE: 11/12/2007
 SHEET: 5 OF 7
 SCALE: N/A

KARAVAN
 TRAILERS
 TITLE: KDP-1820-17/22-SPRING
 MAT'L: SEE B.O.M.
 FINISH: N/A
 DWG. #: KDP-1820-17-22-SPRING

MODEL #	DIMENSIONS				
	"A"	"B"	"F"	"K"	"S"
*	22.0	7.0	5.5	15.0	13.0

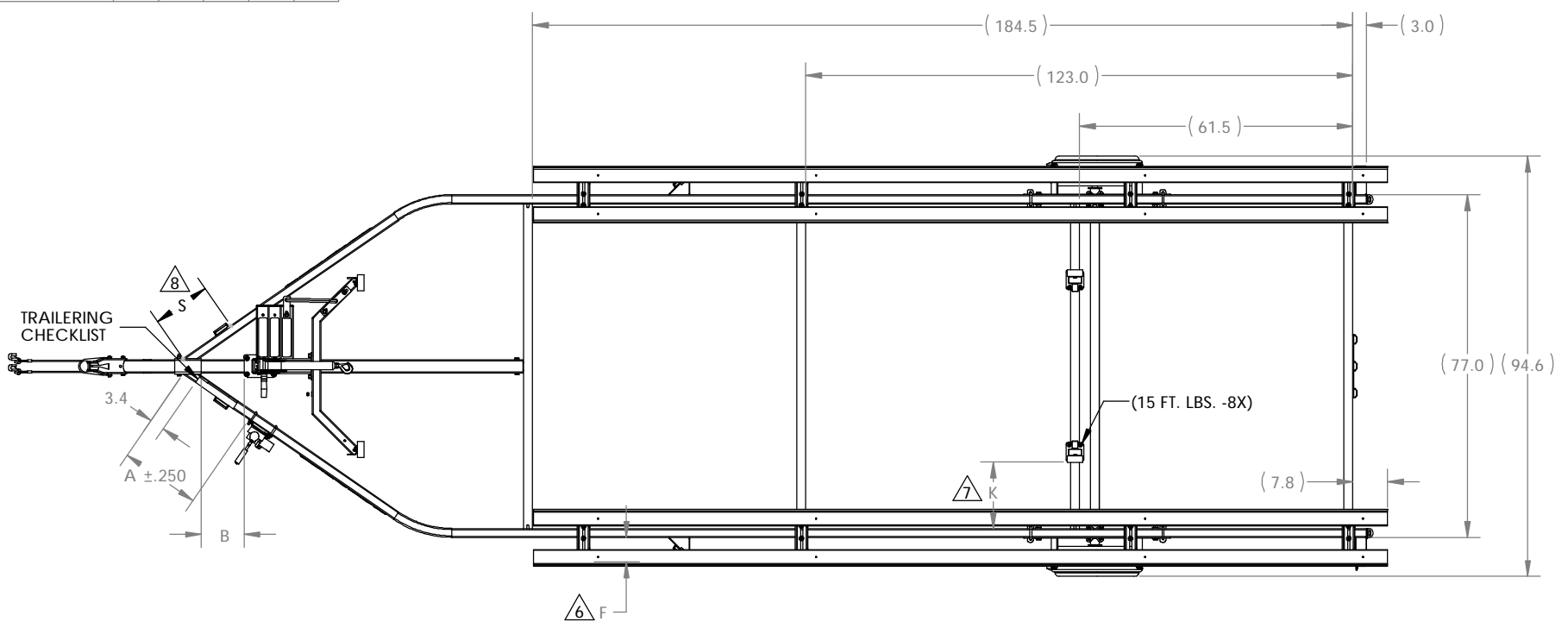

NOTES:

- 6 BUNK LOCATION IS THE DISTANCE FROM THE OUTSIDE OF THE SIDE TUBE TO THE OUTSIDE EDGE OF THE BUNK BRACKET.
- 7 GUIDE-ON LOCATION IS THE DISTANCE FROM THE INSIDE EDGE OF THE SIDE TUBE TO THE OUTSIDE EDGE OF THE GUIDE-ON BRACKET.
- 8 DIMENSION INDICATES THE SET LOCATION OF THE RIGHT SIDE OF THE PIN STAMPER.

M	15457	LJW	01-31-12	UPDATED PRINT PER NEW STANDARD
L	15424	KMH	12-02-11	44.00" FENDER DIMENSION (E) WAS 62.00"
DWG. REV.	ECR/NDR NUMBER	REVISED BY	DATE	DESCRIPTION

ALL DIMENSIONS ARE IN INCHES UNLESS OTHERWISE STATED TOLERANCES EXCEPT AS NOTED

DECIMALS:

.X	±0.100
.XX	±0.060
.XXX	±0.030
.XXXX	±0.010

ANGLES: ±1°

ALL FORMED ANGLES EQUAL 90° UNLESS NOTED OTHERWISE

() INDICATES REFERENCE

THE INFORMATION IN THIS DRAWING IS THE SOLE PROPERTY OF KARAVAN TRAILERS, INC. ANY REPRODUCTION IN PART OR WHOLE WITHOUT THE WRITTEN PERMISSION OF KARAVAN TRAILERS, INC. IS PROHIBITED.

APPROVED BY: ---

DRAWN BY: MJ HALFMANN

DATE: 11/12/2007

SHEET: 6 OF 7

SCALE: N/A

KARAVAN TRAILERS

TITLE: KDP-1820-17/22-SPRING

MAT'L: SEE B.O.M.

FINISH: N/A

DWG. #KDP-1820-17-22-SPRING

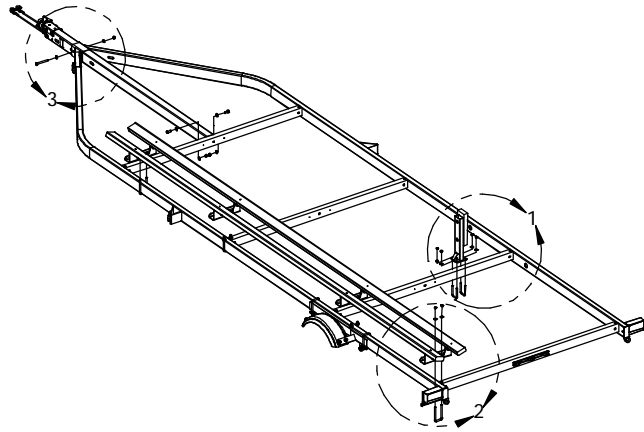

GUIDE-ON MOUNTING INSTRUCTIONS

VIEW 1

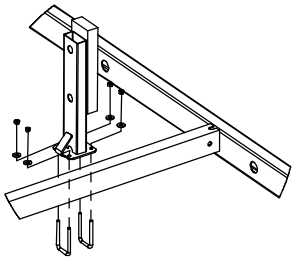

BUNK MOUNTING INSTRUCTIONS

VIEW 2

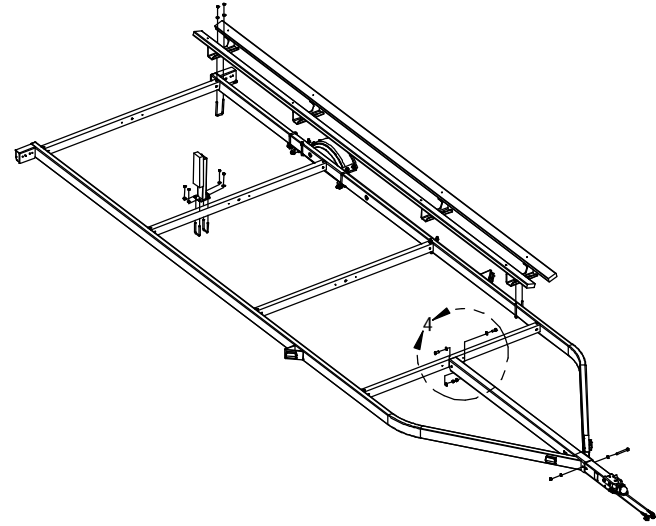
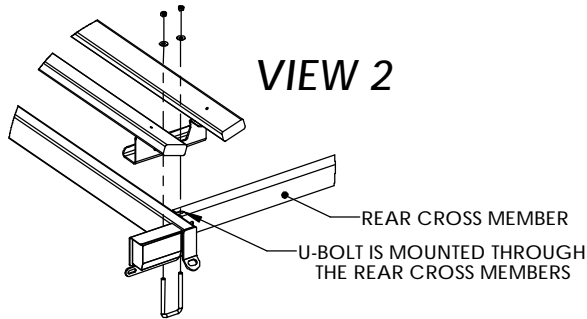

TONGUE MOUNTING INSTRUCTIONS

VIEW 3

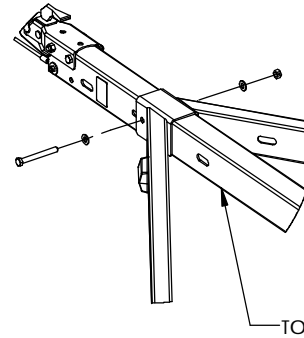

VIEW 4

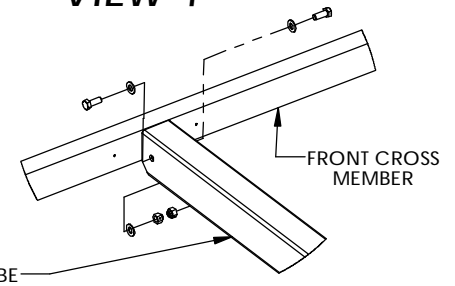

DWG. REV.	ECR/NDR NUMBER	REVISED BY	DATE	DESCRIPTION
M	15457	LJW	01-31-12	UPDATED PRINT PER NEW STANDARD
L	15424	KMH	12-02-11	44.00" FENDER DIMENSION (E) WAS 62.00"

ALL DIMENSIONS ARE IN INCHES UNLESS OTHERWISE STATED TOLERANCES EXCEPT AS NOTED DECIMALS:
 .X ±0.100
 .XX ±0.060
 .XXX ±0.030
 .XXXX ±0.010
 ANGLES:
 ±1°
 ALL FORMED ANGLES EQUAL 90° UNLESS NOTED OTHERWISE
 () INDICATES REFERENCE

THE INFORMATION IN THIS DRAWING IS THE SOLE PROPERTY OF KARAVAN TRAILERS, INC. ANY REPRODUCTION IN PART OR WHOLE WITHOUT THE WRITTEN PERMISSION OF KARAVAN TRAILERS, INC. IS PROHIBITED.
 APPROVED BY: ---
 DRAWN BY: MJ HALFMANN
 DATE: 11/12/2007
 SHEET: 7 OF 7
 SCALE: N/A

KARAVAN TRAILERS	
TITLE:	KDP-1820-17/22-SPRING
MAT'L:	SEE B.O.M.
FINISH:	N/A
DWG. #:	KDP-1820-17-22-SPRING