

K	15457	LJW	01-30-12	UPDATED PRINT PER STANDARD
J	15424	KMH	12-02-11	46.25' FENDER DIM. (E) WAS 62.25'
DWG. REV.	ECR/NDR NUMBER	REVISED BY	DATE	DESCRIPTION

ALL DIMENSIONS ARE IN INCHES  
UNLESS OTHERWISE STATED  
TOLERANCES EXCEPT AS NOTED  
DECIMALS:  
.X ±0.100  
.XX ±0.060  
.XXX ±0.030  
.XXXX ±0.010  
ANGLES:  
±1°  
ALL FORMED ANGLES  
EQUAL 90° UNLESS  
NOTED OTHERWISE  
( ) INDICATES REFERENCE

THE INFORMATION IN THIS DRAWING IS THE SOLE  
PROPERTY OF KARAVAN TRAILERS, INC. ANY  
REPRODUCTION IN PART OR WHOLE WITHOUT  
THE WRITTEN PERMISSION OF KARAVAN TRAILERS,  
IS PROHIBITED.  
APPROVED BY: ---  
DRAWN BY: MJ HALFMANN  
DATE: 11/09/2007  
SHEET: 1 OF 7  
SCALE: N/A

**KARAVAN**  
TRAILERS  
TITLE: KDP-1618-17/22-SPRING  
MAT'L: SEE B.O.M.  
FINISH: N/A  
DWG. #: KDP-1618-17-22-SPRING

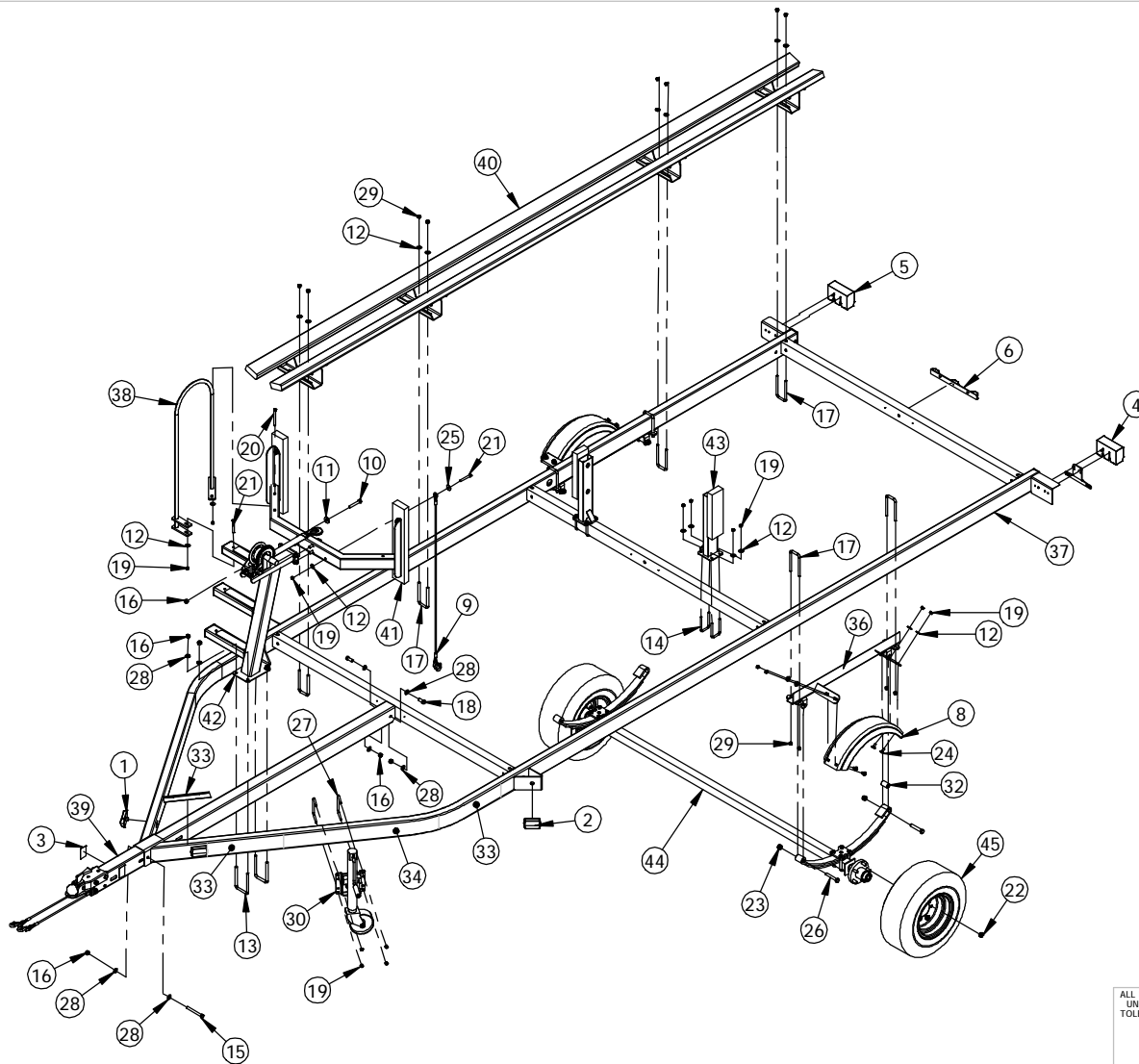

ITEM NO.	SEE NOTES	PART NUMBER	DESCRIPTION	QTY.
1	2	205-00105	AMBER SIDE LIGHT	2
2	2	205-00106	AMBER SIDE LIGHT	2
3		205-00142	AMBER REFLECTOR TAPE	2
4	2	205-00157	TAIL LIGHT LH	1
5	2	205-00158	TAIL LIGHT R.H.	1
6	2	205-00163	I.D. BAR LIGHT SUBM.	1
7	2	205-00170	WIRE HARNESS	1
8		206-00039	FENDER	2
9		208-00046	SAFETY CABLE & HOOK	1
10		210-00012	50"-13 X 3.00" HX HD BOLT	4
11		210-00017	50" FLAT WASHER	4
12		210-00025	.375" FLAT WASHER	36
13		210-00030	50"-13 X 3.063" X 5.25" U-BOLT	2
14		210-00031	.375"-16 X 2.031" X 3.75" U-BOLT	4
15		210-00040	50"-13 X 4.50" HX HD BOLT	1
16		210-00061	50"-13 CENTERLOCK HEX NUT	11
17		210-00068	.438"-14 X 2.25" X 5.31" U-BOLT	12
18		210-00072	50"-13 X 1.25" HX HD BOLT	2
19		210-00076	.375"-16 CENTERLOCK HEX NUT	24
20		210-00080	.375"-16 X 4.00" HX HD BOLT	2
21		210-00089	.375"-16 X 3.00" HX HD BOLT	2
22		210-00137	.50"-20 X .813" LUG NUT	10
23		210-00157	.563"-12 NYLOCK HEX NUT	4
24		210-00194	.375"-16 X .875" CARRIAGE BOLT	8
25		210-00207	.375" FLAT WASHER	1
26		210-00211	.563"-12 X 3.25" HX HD BOLT	4
27		210-00231	.375"-16 X 3.00" X 4.06" U-BOLT	2
28		210-00240	.50" SAE FLAT WASHER ZINC	10
29		210-00330	.438"-14 CENTERLOCK HEX NUT	24
30		214-00008	TONGUE JACK	1
31		229-00006	LICENSE PLATE BRACKET	1
32		229-00095	BUSHING	2
33		234-00032	TRAILERING CHECKLIST	1
34		234-00058	LOGO	4
35		234-00060	LOGO	2
36		300-00953	SPRING HANGER	2
37		300-01669	FRAME WELDMENT	1
38		300-01673	HAND RAIL WELD	1
39	1	310-01891	TONGUE ASSY.	1
40	1	310-01997	BUNK ASSY	2
41		310-02017	WINCH BOARD ASSY	1
42		310-02018	WINCH ASSY.	1
43	1	310-02292	GUIDE-ON ASSY.	2
44	3	AXLE ASSY	SEE OPTIONS	1
45	3	TIRE	SEE OPTIONS	2

- NOTES:
- 1.) SEE ADDITIONAL INSTRUCTIONS ON PAGE SEVEN.
  - 2.) SEE ADDITIONAL INSTRUCTIONS ON PAGE FOUR.
  - 3.) SEE OPTIONS ON PAGE THREE.

K	15457	LJW	01-30-12	UPDATED PRINT PER STANDARD
J	15424	KMH	12-02-11	46.25" FENDER DIM. (E) WAS 62.25"
DWG. REV.	ECR/NDR NUMBER	REVISED BY	DATE	DESCRIPTION

ALL DIMENSIONS ARE IN INCHES UNLESS OTHERWISE STATED TOLERANCES EXCEPT AS NOTED DECIMALS:

.X ±0.100  
 .XX ±0.060  
 .XXX ±0.030  
 .XXXX ±0.010

ANGLES: ±1°

ALL FORMED ANGLES EQUAL 90° UNLESS NOTED OTHERWISE

( ) INDICATES REFERENCE

THE INFORMATION IN THIS DRAWING IS THE SOLE PROPERTY OF KARAVAN TRAILERS, INC. ANY REPRODUCTION IN PART OR WHOLE WITHOUT THE WRITTEN PERMISSION OF KARAVAN TRAILERS, INC. IS PROHIBITED.

APPROVED BY: ---  
 DRAWN BY: M. HALFMANN  
 DATE: 11/09/2007  
 SHEET: 2 OF 7  
 SCALE: N/A

**KARAVAN**  
TRAILERS

TITLE: KDP-1618-17/22-SPRING

MAT'L: SEE B.O.M.

FINISH: N/A

DWG. #: KDP-1618-17-22-SPRING

**TONGUE TUBE OPTIONS**

3" X 5" X 118"  
3" X 5" X 142"

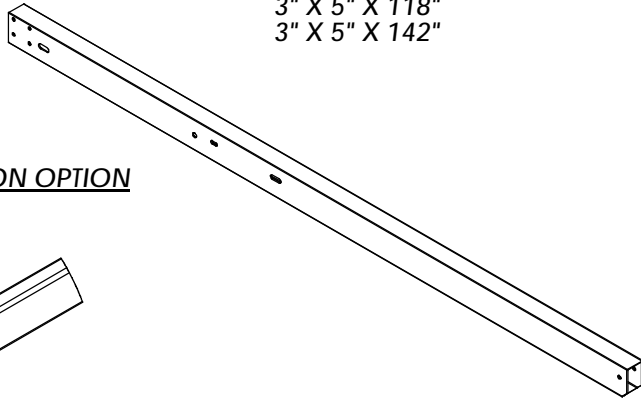

**TRITOON KIT OPTIONS**

2" X 4" CARPET  
2" X 4" PLASTIC  
2" X 6" CARPET  
2" X 6" PLASTIC

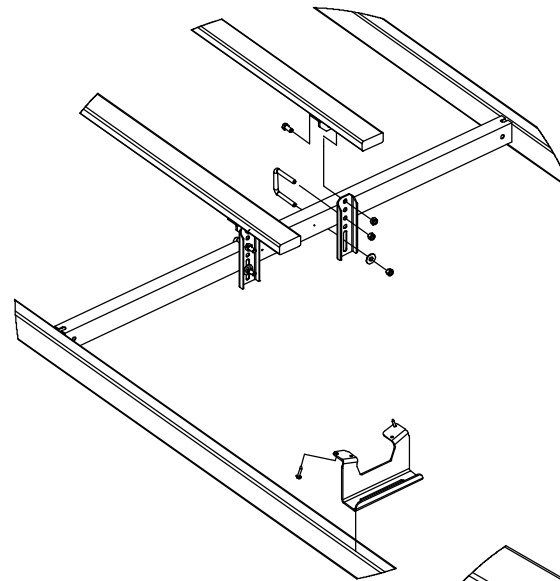

**HORIZONTAL GUIDE ON OPTION**

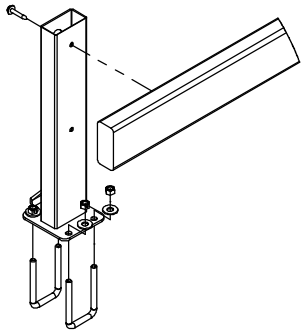

**CARPET BUNK OPTIONS**

2" X 4" X 192"  
2" X 6" X 168"  
2" X 6" X 192"

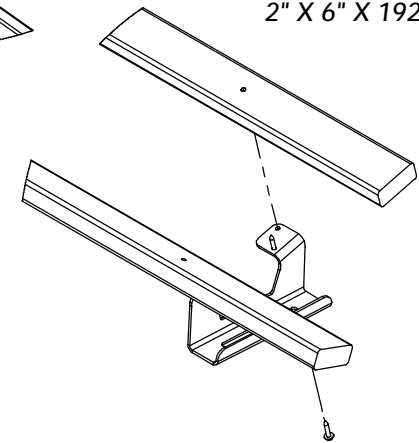

**PLASTIC BUNK OPTIONS**

2" X 4" X 168"  
2" X 4" X 192"  
2" X 6" X 168"  
2" X 6" X 192"

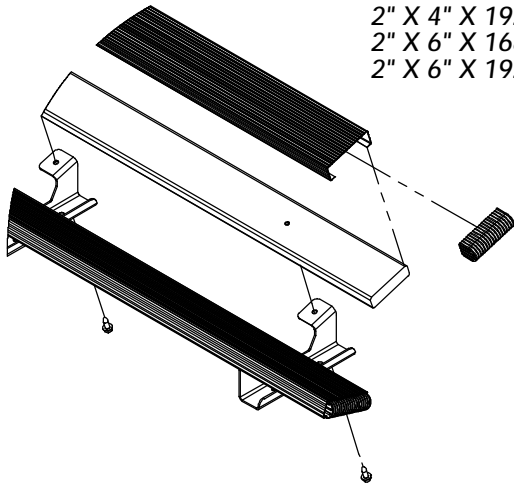

OPTIONS			
KDP-1618-17 20.5 X 8-10E	KDP-1618-17 5.30 X 12D		KDP-1618-22 20.5 X 8-10E
310-01894	310-01894	AXLE ASSEMBLY	310-01899
220-00085	220-00060	TIRES	220-00085

K	15457	LJW	01-30-12	UPDATED PRINT PER STANDARD
J	15424	KMH	12-02-11	46.25" FENDER DIM. (E) WAS 62.25"
DWG. REV.	ECR/NDR NUMBER	REVISED BY	DATE	DESCRIPTION

ALL DIMENSIONS ARE IN INCHES  
UNLESS OTHERWISE STATED  
TOLERANCES EXCEPT AS NOTED  
DECIMALS:  
.X \$0.100  
.XX \$0.060  
.XXX \$0.030  
.XXXX \$0.010  
ANGLES:  
±1°  
ALL FORMED ANGLES  
EQUAL 90° UNLESS  
NOTED OTHERWISE  
( ) INDICATES REFERENCE

THE INFORMATION IN THIS DRAWING IS THE SOLE  
PROPERTY OF KARAVAN TRAILERS, INC. ANY  
REPRODUCTION IN PART OR WHOLE WITHOUT  
THE WRITTEN PERMISSION OF KARAVAN TRAILERS,  
IS PROHIBITED.  
APPROVED BY: ---  
DRAWN BY: MJ HALFMANN  
DATE: 11/09/2007  
SHEET: 3 OF 7  
SCALE: N/A

**KARAVAN**  
TRAILERS

TITLE: KDP-1618-17/22-SPRING  
MAT'L: SEE B.O.M.  
FINISH: N/A  
DWG. #: KDP-1618-17-22-SPRING

**VIEW A**  
GREEN & WHITE WIRES RUN  
DOWN RIGHT SIDE TUBE.

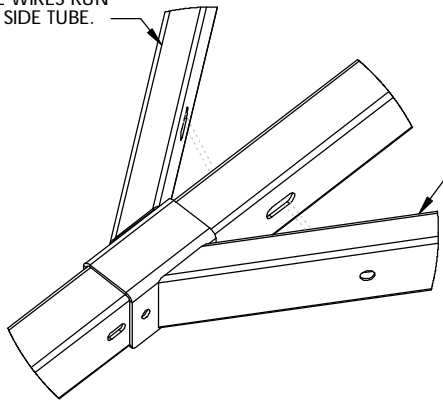

YELLOW WIRE RUNS  
DOWN LEFT SIDE TUBE.

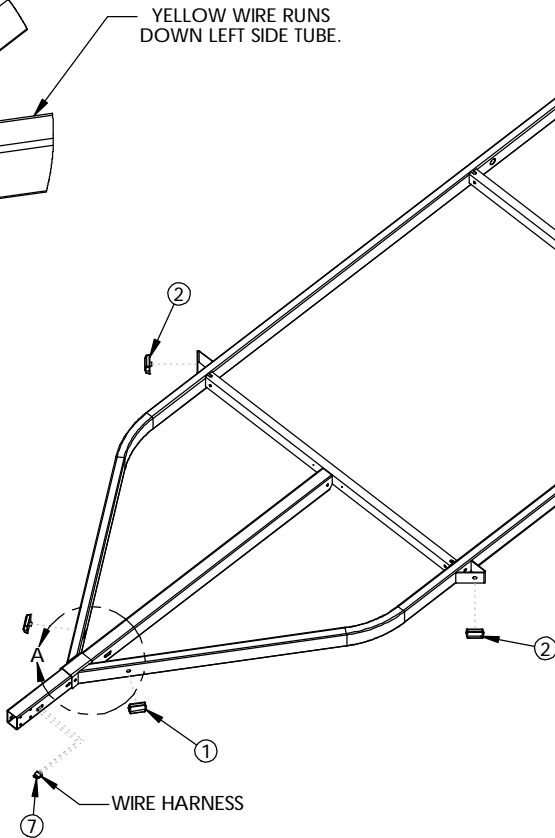

THE TAIL LIGHT IS  
MOUNTED TO THE CENTER  
HOLES OF THE TAIL  
LIGHT BRACKET.



THE TAIL LIGHT IS  
MOUNTED TO THE CENTER  
HOLES OF THE TAIL  
LIGHT BRACKET.

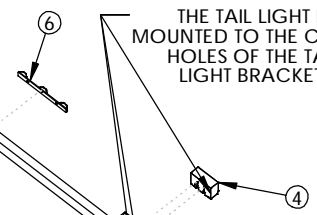

**VIEW B**

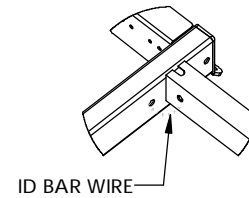

WIRE HARNESS

ALL DIMENSIONS ARE IN INCHES  
UNLESS OTHERWISE STATED  
TOLERANCES EXCEPT AS NOTED  
DECIMALS:  
.X ±0.100  
.XX ±0.060  
.XXX ±0.030  
.XXXX ±0.010  
ANGLES:  
±1°  
ALL FORMED ANGLES  
EQUAL 90° UNLESS  
NOTED OTHERWISE  
( ) INDICATES REFERENCE

THE INFORMATION IN THIS DRAWING IS THE SOLE  
PROPERTY OF KARAVAN TRAILERS, INC. ANY  
REPRODUCTION IN PART OR WHOLE WITHOUT  
THE WRITTEN PERMISSION OF KARAVAN TRAILERS,  
INC. IS PROHIBITED.  
APPROVED BY: ---  
DRAWN BY: MJ HALFMANN  
DATE: 11/09/2007  
SHEET: 4 OF 7  
SCALE: N/A

**KARAVAN**  
TRAILERS

TITLE: KDP-1618-17/22-SPRING

MAT'L: SEE B.O.M.

FINISH: N/A

DWG. #: KDP-1618-17-22-SPRING

K	15457	LJW	01-30-12	UPDATED PRINT PER STANDARD
J	15424	KMH	12-02-11	46.25" FENDER DIM. (E) WAS 62.25"
DWG. REV.	ECR/NDR NUMBER	REVISED BY	DATE	DESCRIPTION

MODEL #	DIMENSIONS		
	"D"	"E"	"P"
*	187.0	46.25	30.0

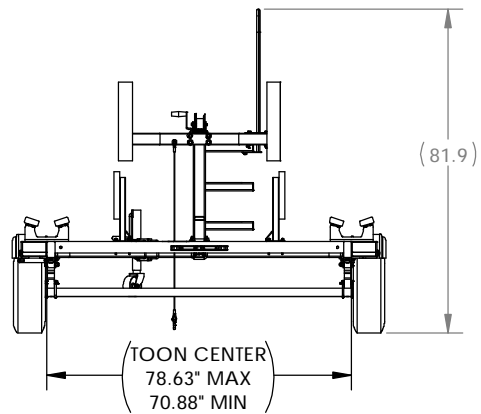
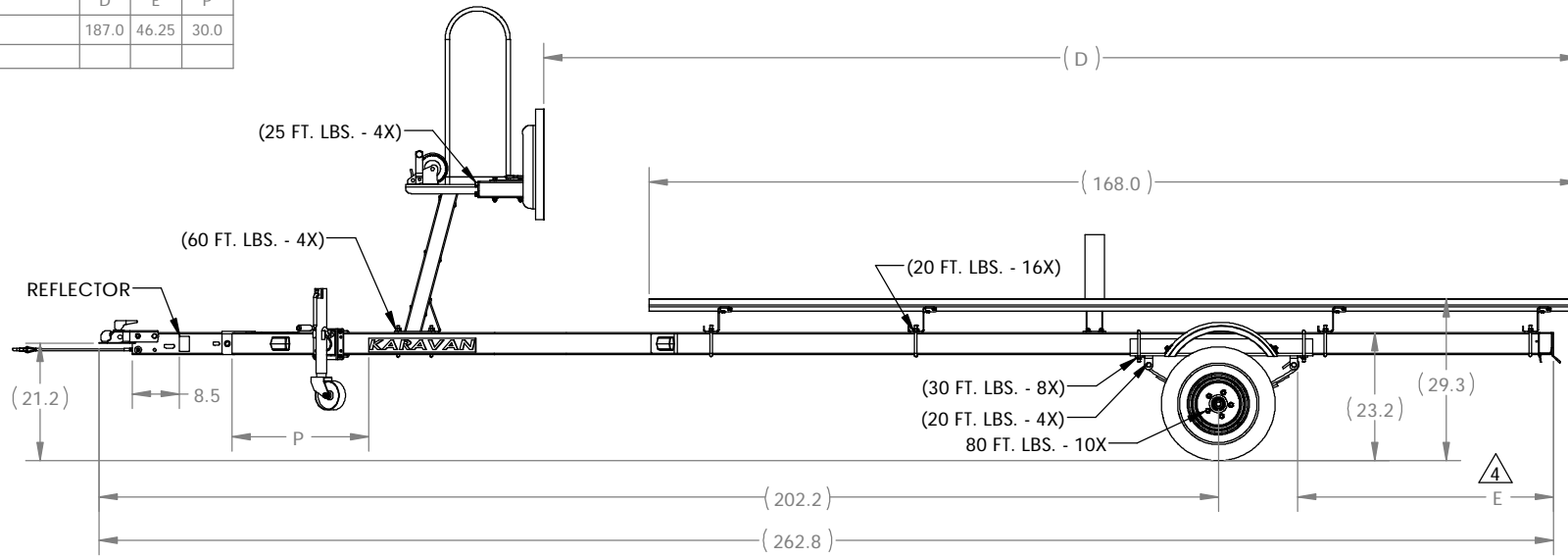

NOTES:

**4** DIMENSION IS FROM THE BACK OF THE SPRING HANGER TO THE BACK OF THE FRAME.

5.) TORQUE CALLOUTS IN PARENTHESIS ARE FOR REFERENCE. TIGHTEN FASTENERS UNTIL PINCHED TIGHT (DO NOT OVERTIGHTEN BUNK PIVOT POINTS). MINOR DEFLECTION OF MATERIAL IS ACCEPTABLE

DWG. REV.	ECR/NDR NUMBER	REVISED BY	DATE	DESCRIPTION
K	15457	LJW	01-30-11	UPDATED PRINT PER STANDARD
J	15424	KMH	12-02-11	46.25" FENDER DIM. (E) WAS 62.25"

ALL DIMENSIONS ARE IN INCHES UNLESS OTHERWISE STATED TOLERANCES EXCEPT AS NOTED

DECIMALS:  
 .X ±0.100  
 .XX ±0.060  
 .XXX ±0.030  
 .XXXX ±0.010

ANGLES:  
 ±1°

ALL FORMED ANGLES EQUAL 90° UNLESS NOTED OTHERWISE

( ) INDICATES REFERENCE

THE INFORMATION IN THIS DRAWING IS THE SOLE PROPERTY OF KARAVAN TRAILERS, INC. ANY REPRODUCTION IN PART OR WHOLE WITHOUT THE WRITTEN PERMISSION OF KARAVAN TRAILERS, INC. IS PROHIBITED.

APPROVED BY: ---  
 DRAWN BY: MJ HALFMANN  
 DATE: 11/09/2007  
 SHEET: 5 OF 7  
 SCALE: N/A

<b>KARAVAN</b> TRAILERS	
TITLE:	KDP-1618-17/22-SPRING
MAT'L:	SEE B.O.M.
FINISH:	N/A
DWG. #:	KDP-1618-17-22-SPRING

MODEL #	DIMENSIONS				
	"A"	"B"	"F"	"K"	"S"
*	22.0	23.2	5.5	15.0	13.0

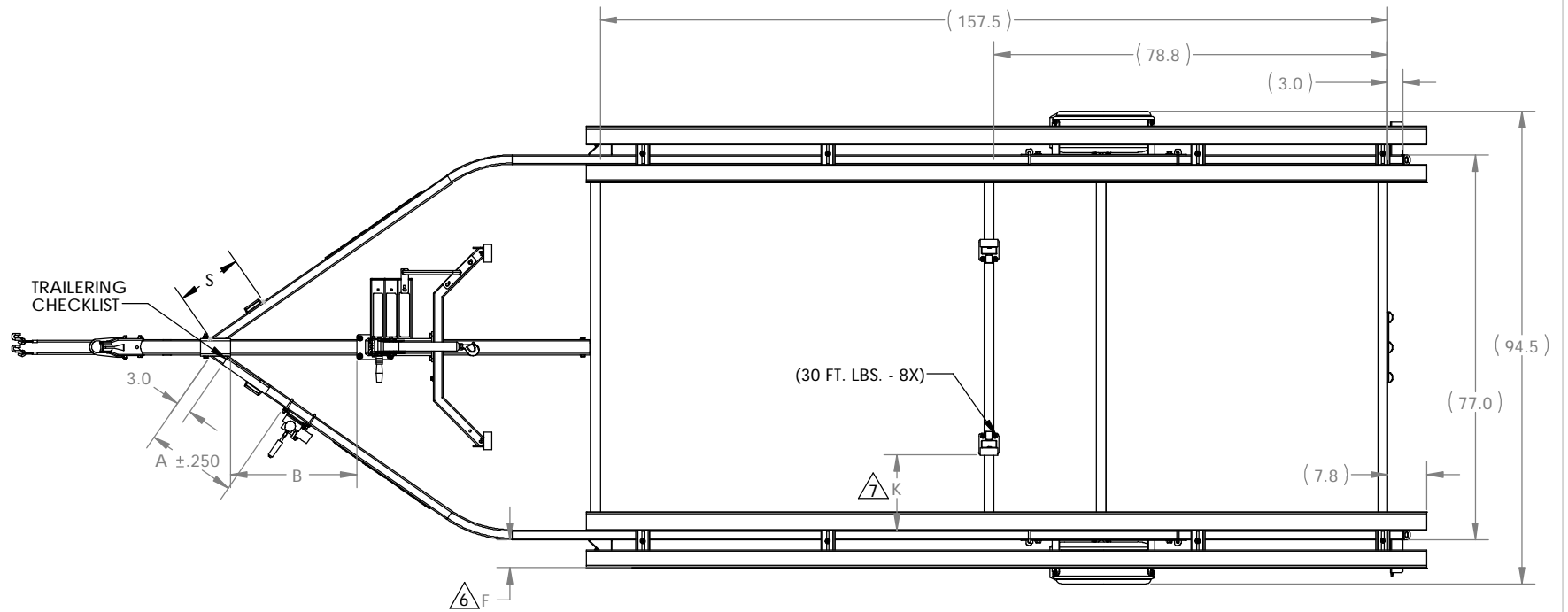

- NOTES:
- 6 BUNK LOCATION IS THE DISTANCE FROM THE OUTSIDE OF THE SIDE TUBE TO THE OUTSIDE EDGE OF THE BUNK BRACKET.
- 7 GUIDE-ON LOCATION IS THE DISTANCE FROM THE INSIDE EDGE OF THE SIDE TUBE TO THE OUTSIDE EDGE OF THE GUIDE-ON BRACKET.

DWG. REV.	ECR/NDR NUMBER	REVISED BY	DATE	DESCRIPTION
K	15457	LJW	01-30-12	UPDATED PRINT PER STANDARD
J	15424	KMH	12-02-11	46.25" FENDER DIM. (E) WAS 62.25"

ALL DIMENSIONS ARE IN INCHES UNLESS OTHERWISE STATED TOLERANCES EXCEPT AS NOTED

DECIMALS:

.X \$0.100  
 .XX \$0.060  
 .XXX \$0.030  
 .XXXX \$0.010

ANGLES:  
 ±1\*

ALL FORMED ANGLES EQUAL 90° UNLESS NOTED OTHERWISE

( ) INDICATES REFERENCE

THE INFORMATION IN THIS DRAWING IS THE SOLE PROPERTY OF KARAVAN TRAILERS, INC. ANY REPRODUCTION IN PART OR WHOLE WITHOUT THE WRITTEN PERMISSION OF KARAVAN TRAILERS, INC. IS PROHIBITED.

APPROVED BY: ---

DRAWN BY: MJ HALFMANN

DATE: 11/09/2007

SHEET: 6 OF 7

SCALE: N/A

**KARAVAN**  
TRAILERS

TITLE: KDP-1618-17/22-SPRING

MAT'L: SEE B.O.M.

FINISH: N/A

DWG. #: KDP-1618-17-22-SPRING

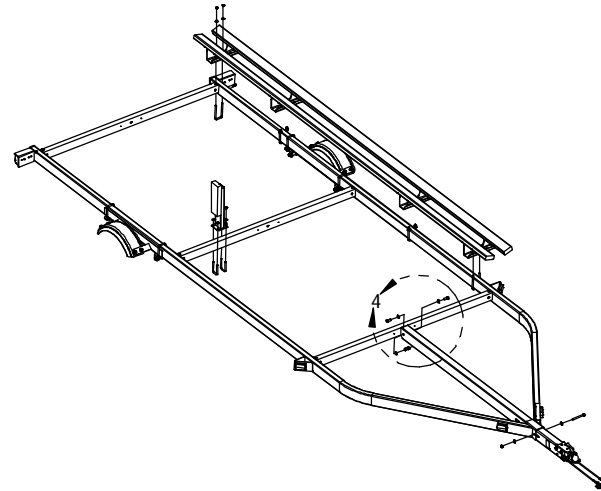
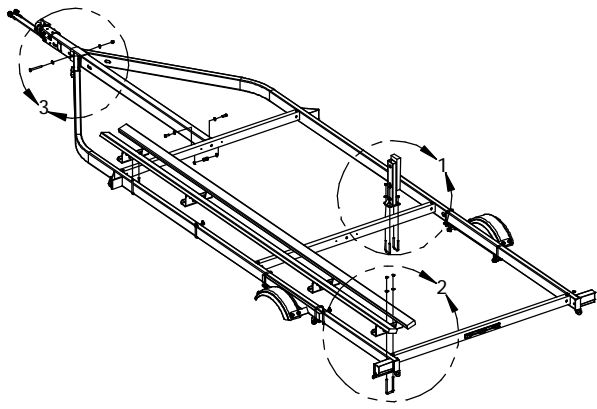

**GUIDE-ON MOUNTING INSTRUCTIONS**

**BUNK MOUNTING INSTRUCTIONS**

**TONGUE MOUNTING INSTRUCTIONS**

VIEW 1

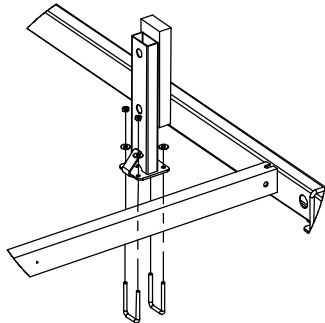

VIEW 2

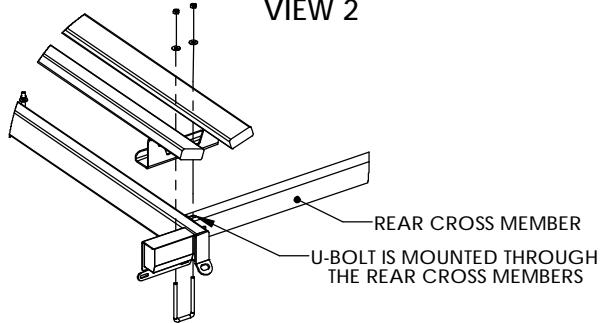

VIEW 3

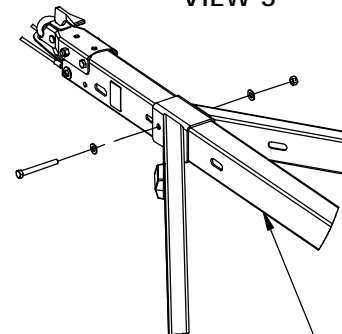

VIEW 4

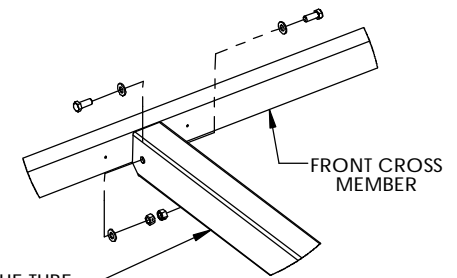

K	15457	LJW	01-30-12	UPDATED PRINT PER STANDARD
J	15424	KMH	12-02-11	46.25" FENDER DIM. (E) WAS 62.25"
DWG. REV.	ECR/NDR NUMBER	REVISED BY	DATE	DESCRIPTION

ALL DIMENSIONS ARE IN INCHES UNLESS OTHERWISE STATED TOLERANCES EXCEPT AS NOTED DECIMALS:  
 .X ±0.100  
 .XX ±0.060  
 .XXX ±0.030  
 .XXXX ±0.010  
 ANGLES: ±1°  
 ALL FORMED ANGLES EQUAL 90° UNLESS NOTED OTHERWISE  
 ( ) INDICATES REFERENCE

THE INFORMATION IN THIS DRAWING IS THE SOLE PROPERTY OF KARAVAN TRAILERS, INC. ANY REPRODUCTION IN PART OR WHOLE WITHOUT THE WRITTEN PERMISSION OF KARAVAN TRAILERS, INC. IS PROHIBITED.  
 APPROVED BY: ---  
 DRAWN BY: MJ HALFMANN  
 DATE: 11/09/2007  
 SHEET: 7 OF 7  
 SCALE: N/A

<b>KARAVAN TRAILERS</b>	
TITLE:	KDP-1618-17/22-SPRING
MAT'L:	SEE B.O.M.
FINISH:	N/A
DWG. #:	KDP-1618-17-22-SPRING