

The Transom Saver

by Shore Land'r

6133400 Galvanized Transom Saver Assembly - 22"

6133300 Galvanized Transom Saver Assembly - 41"

NOTE: The Transom Saver is adjustable 6 inches on each end for a total of 12 inches of adjustment. If the unit needs to be shorter, the center tube may be cut to the desired length and redrilled to accommodate the end unit.

Fishing Series: The Transom Saver is secured to the trailer by rotating the Transom Saver 90 degrees and inserting it into the slotted hole in the rear crossmember or rear pivot. If the trailer has an 8 inch keel roller bracket, the unit may be secured into the vertical adjustment slot.

2X3 & 2X4 Frames: Remove the 3/8" lock nut that secures the plastic protector pad to the rear pivot or rear crossmember and attach the mounting bracket. Secure the bracket with the 3/8" lock nut that was earlier removed and tighten. Rotate the Transom Saver 90 degrees and insert it into the slot in the bracket. When the unit is returned to its normal position, the Transom Saver is locked in the bracket.

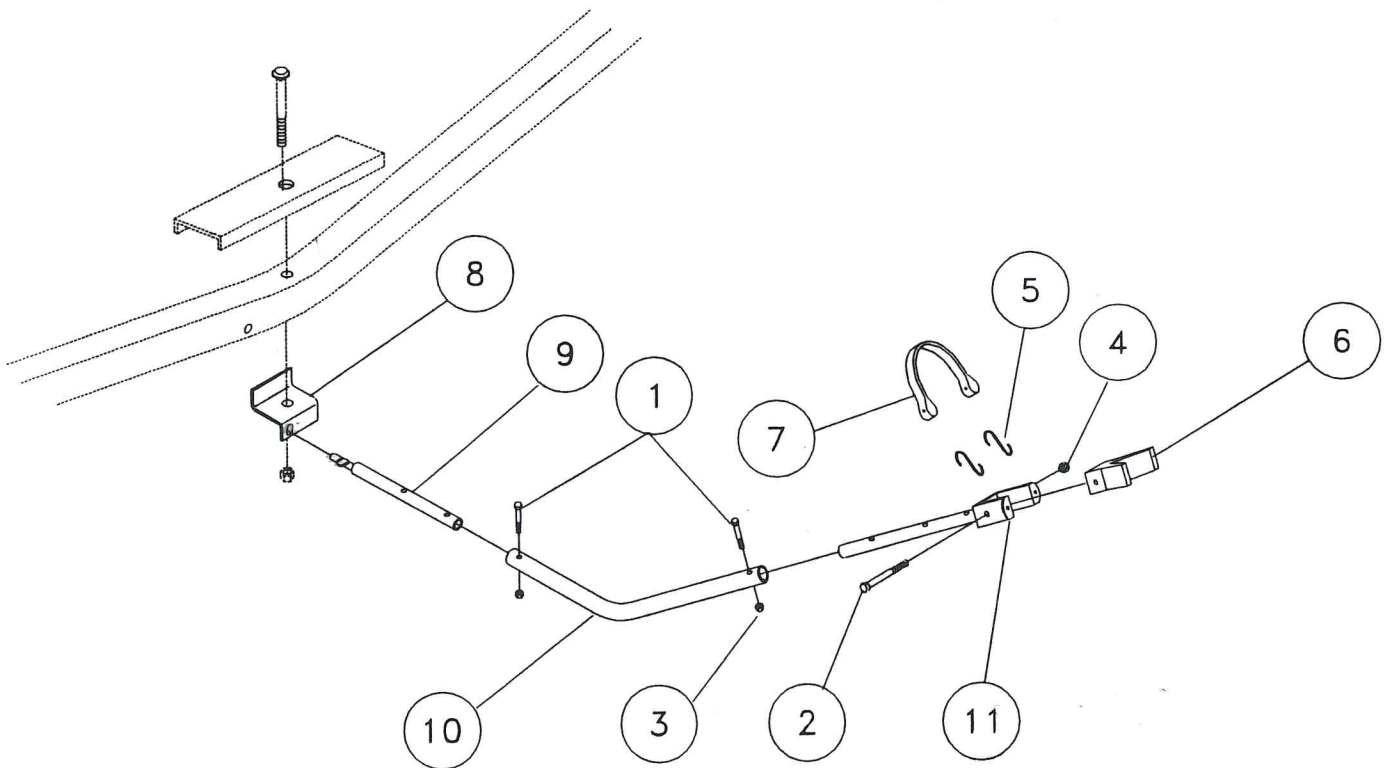

Material List for the 22" and 41" Galvanized Transom Saver Assemblies

REF.#	PART#	DESCRIPTION	QTY.	REF.#	PART#	DESCRIPTION	QTY.
1	0110021	1/4" X 1-1/2" HEX BOLT	2	8	6129510	TRANSOM SAVER MOUNTING BRACKET	1
2	0120052	3/8" X 2-3/4" HEX BOLT	1	9	6131800	ADJUSTABLE TRANSOM SAVER WELDMENT	1
3	1410059	1/4" HEX LOCK NUT	2	10	62288	24-1/2" TRANSOM SAVER TUBE	1
4	1440101	3/8" FLANGE LOCK NUT	1	—	61335	41" TRANSOM SAVER TUBE	1
5	1920010	2-1/2" "S" HOOK	2	11	6228900	V-BLOCK MOUNT WELDMENT - 3-HOLE	1
6	3510069	V-BLOCK FOR TRANSOM SAVER	1				
7	3520005	10" RUBBER TIE-DOWN STRAP	1				

MIDWEST INDUSTRIES, INC.
IDA GROVE, IOWA 51445 TEL (712) 364-3365