

TA1224-00 Spare Tire Kit for the 4X8 I-Beam, Aluminum Trailers: 9500 lb. & 15000 lb.

BILL OF MATERIALS			
ITEM	PART #	DESCRIPTION	QTY
1	67574	SPARE TIRE BRKT 3X8 FRAME ZYU	1
2	0110096	HH 1/2-20 X 1-1/2	3
3	0340203	SUB 1/2 X 4 9/16 X 9 1/4	2
4	1410209	HEX LOCKNUT 1/2-20	3
5	1410229	HEX LUGNUT 1/2-20 13/16 OD Z&U	3
6	1450357	HEX LOCKNUT NYLON 1/2-13 STAINLESS	4

NOTE:
STUD LOCATION FOR THE
SL150T, & SL95T
ALUM, TRAILERS

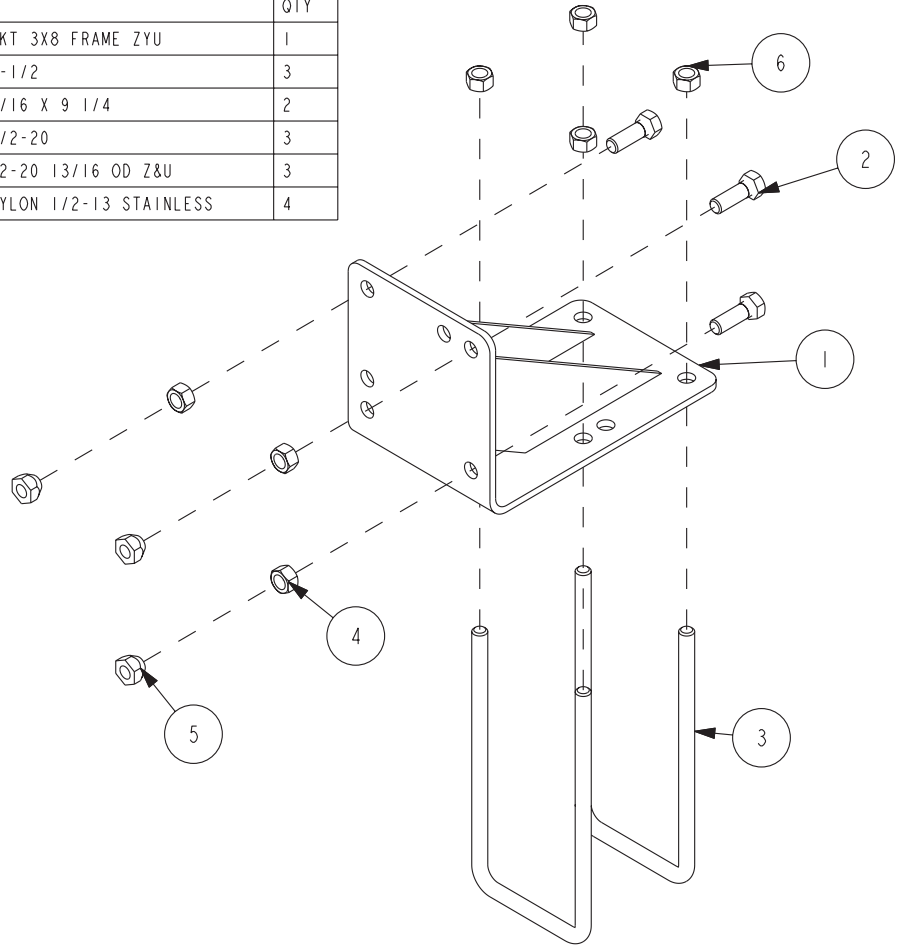

Mount the TA1224 spare tire bracket assembly on your trailer's side frame that faces away from traffic and closest to the tongue of your trailer.

Place the spare tire bracket on the top of the side frame.

Secure the spare tire bracket with 1/2" u-bolts from under the side frame upward. Secure with 1/2" lock nuts. Insert four (4) 1/2" X 1-1/2" hex bolts through the spare tire bracket and secure 1/2" hex lock nuts. Mount the spare tire and secure with 1/2" lug nuts.