



Posi-Lock Hand Winch Instructions

Hand Winches, Single Speed

Models: 5402, 5412, 5421, 5422, 5425, 5430, 5403, 5413, 5413T, 5426, 5404, 5414, 5405, 5415, 5427, 5428, 5494, 5495, 5407, 5407B, 5417, 5429, 5408B, 5409, 5409B

Hand Winches, Dual Speed

Models: 5460, 5461, 5462, 5463, 5466, 5467, 5470, 5471, 5472, 5473, 5474, 5476, 5477, 5480, 5481, 5484



CAUTION: THIS WINCH IS NOT DESIGNED TO BE USED FOR HOISTING OR TRANSFER OF PEOPLE OR HOISTING LOADS OVER PEOPLE OCCUPIED AREAS!

NEVER:

- Leave a weight hanging on the winch while winch is unattended.
- Exceed maximum rated line pull as stamped on the winch housing. Rated line pull is with three (3) wraps of line on the reel.
- Alter the mechanics of the winch.
- Use two or more winch units to lift a load greater than the load rating of any single unit.
- Fully extend the cable. **Always** keep three (3) complete wraps of cable on drum.
- Use to secure trailer or boat in tow, always use proper tie-downs.

ALWAYS:

- Maintain winch as described in this instruction sheet.
- Be sure cable is pulling straight off winch, not at an angle.
- Inspect winch, cable and attachment before each use for damage.
- Use cable of correct rated strength.

WARNING! READ BEFORE OPERATING WINCH. THIS EQUIPMENT SHOULD NOT BE INSTALLED, OPERATED OR MAINTAINED BY ANY INDIVIDUAL WHO HAS NOT READ THE CONTENTS OF THIS DOCUMENT. **FAILURE TO READ AND APPLY THESE INSTRUCTIONS CAN RESULT IN SUDDEN FAILURE OF THE EQUIPMENT, PROPERTY DAMAGE OR SERIOUS INJURY.**

WINCH MOUNTING AND CABLE OR ROPE ATTACHMENT

For maximum safety these winches must be mounted with two (2) 3/8" or M10 bolts (models 5402, 5403, 5404), or with three (3) 3/8" or M10 bolts (models 5405, 5407, 5408, 5409), washers and lock washers (see FIG. 1 and FIG. 2 at right). Attach cable or rope as shown in FIG. 3.

OPERATING INSTRUCTIONS

Wind cable on winch reel by turning winch handle in clockwise direction. This should produce a loud clicking noise. **CAUTION! DO NOT RELEASE HANDLE UNLESS RATCHET PAWL IS PROPERLY ENGAGED. DO NOT DISENGAGE RATCHET PAWL UNLESS TENSION IS APPLIED TO HANDLE. FAILURE TO OBSERVE THESE CAUTIONS WILL CAUSE THE HANDLE TO SPIN OUT OF CONTROL AND COULD CAUSE PERSONAL INJURY.**

WINCH MAINTENANCE

Before operating, check for cracks, breaks, distortions, deformed parts, improper adjustments, loose parts or any other unsafe conditions within all components. Winch gears, ratchet mechanisms and rotating shafts must be clean and lubricated to insure safe and proper operation.

FIG. 1

For models 5402-5409B up to 1400lbs

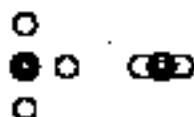

For models 5402-5409B over 1400 lbs.

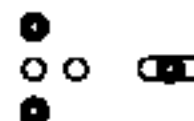
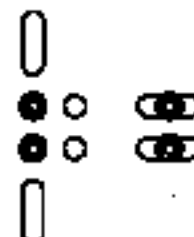

FIG. 2

For models 5460-5464 up to 1400 lbs



For models 5460-5464 over 1400lbs

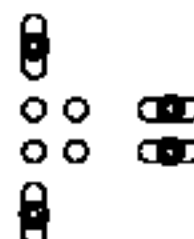
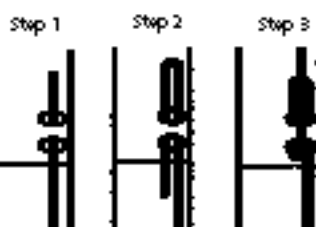

FIG. 3

Large Rope Small Rope or Cable



(Rope or Cable)

Shelby Industries, Inc.

P.O. Box 308 • Shelbyville, KY 40066-0308 • U.S.A.

Phone (502) 633-2040 • Fax (502) 633-2186 • www.shelbyindustries.com

