

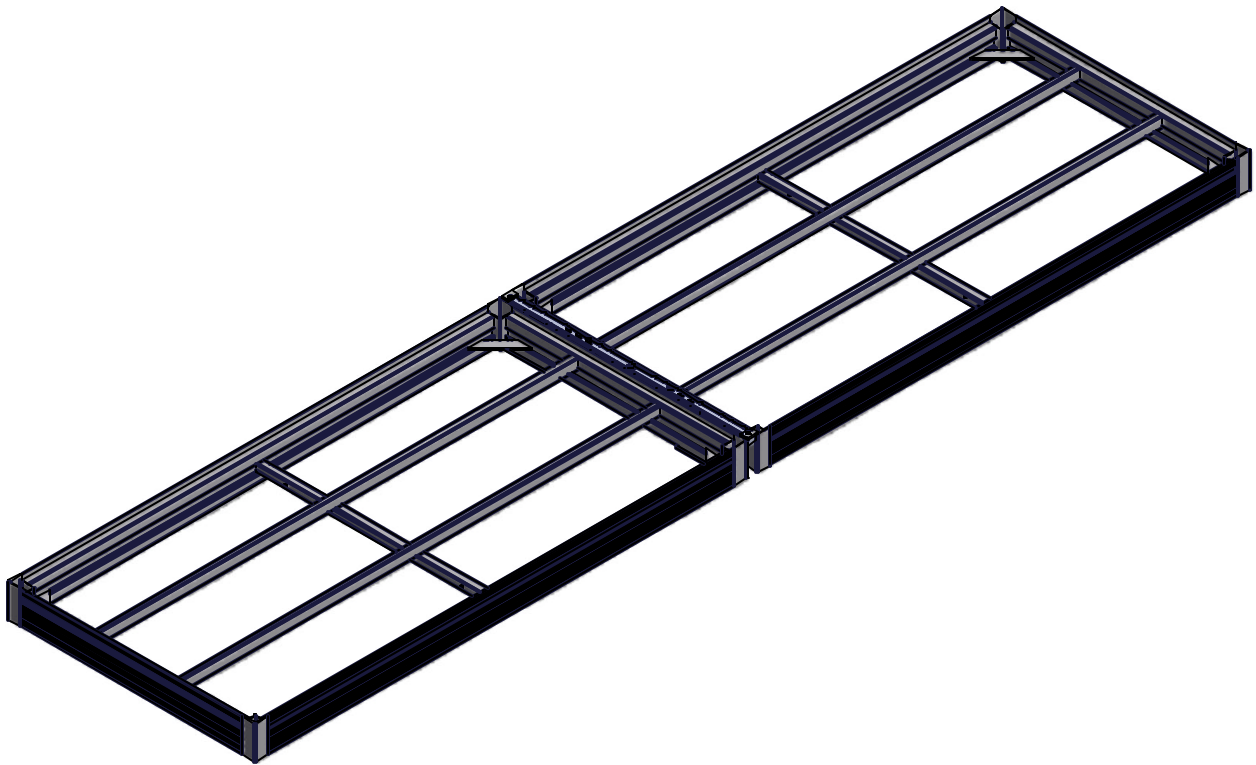

Articulating Hinge



Parts List			
ITEM	QTY	PART NUMBER	DESCRIPTION
1	1	VM-065-03	HINGE SPACER
2	4	VM-065-00	ARTICULATING HINGE XNMT
3	2	VM-065-1	ARTIC. HINGE ROD
4	4	HD-00163	HairPin Cotter Pin S/S
5	8	HD-00059	3/8 X 1" CARRIAGE BOLT S/S
6	8	HD-00056	3/8 FLANGE HUT BRASS

4

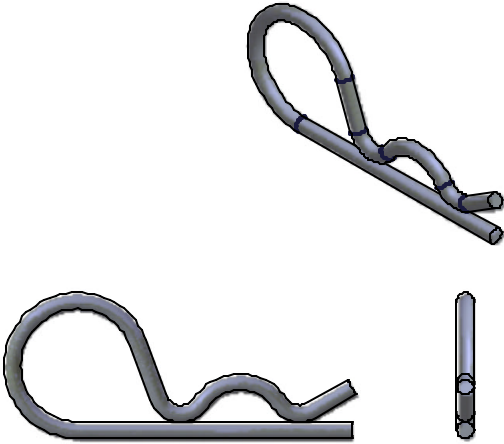

HAIR PIN CLIPS S/S (4 REQ'D)

6



3/8 FLANGE NUT BRASS (8 REQ'D)

5

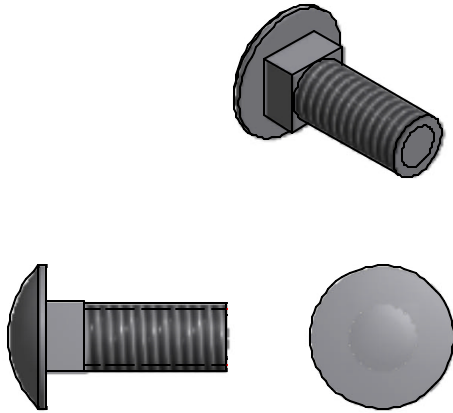

3/8 X 1 CARRIAGE BOLT S/S (8 REQ'D)

2

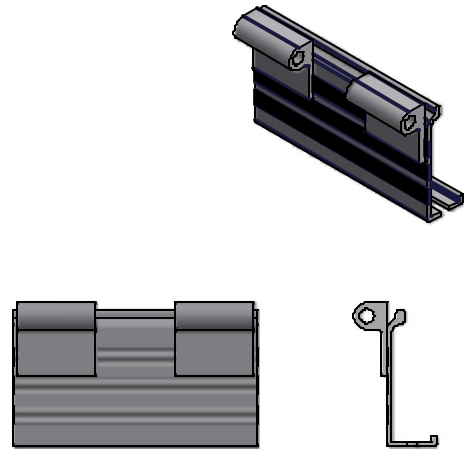

ARTICULATING HINGE (4 REQ'D)

3

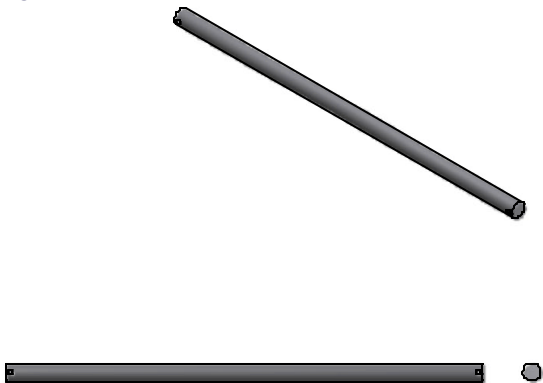

ARTIC HINGE ROD S/S (2 REQ'D)

1

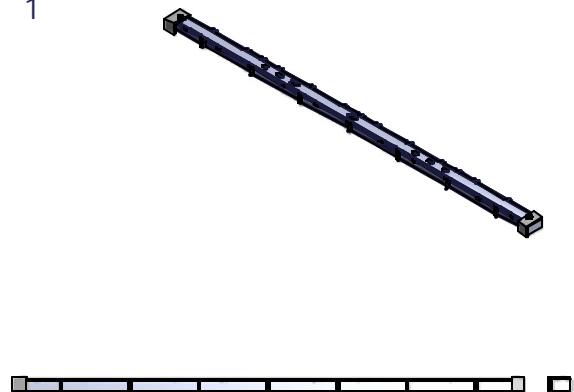

HINGE SPACER (1 REQ'D)

To insure your safety while assembling your Voyager product:

- Fully read and understand the assembly instructions
- Do not assemble this product if items are missing or damaged
- Wear protective gloves, clothing and eye wear when assembling this product
- Check tightness of all hardware each year to avoid injury

❖ *Note: You may need assistance when unhooking dock sections and hooking back together*

Installation procedure

The following tools will be needed: 9/16" wrench, 1/2" wrench

1. Support ends of docks where putting articulating hinge before unhooking.
2. Loosen set bolts on dock connectors with 1/2" wrench and remove. **Per diagram A.**
3. Loosen bolts on add-on brackets and remove. **Per diagram B.**
4. Separate docks to allow enough room to install hinges. **Per diagram C.**
5. Insert head of carriage bolts (4) into raceway on the underside of the rail on dock ends.
Per diagram D.
6. Hook 2 hinge channels to each dock end, keep 1 to each side. **Per diagram E.**
7. Install 2 carriage bolts and flange nuts to each hinge. Leave nuts loose at this time.
8. Slide docks together and install pins in hinges. **Per diagram E.**
9. Set spacing on hinges **Per diagram F** and tighten bolts with 9/16" wrench.
10. Install hinge spacer over articulating hinge. **Per diagram G.**

DIAGRAM A

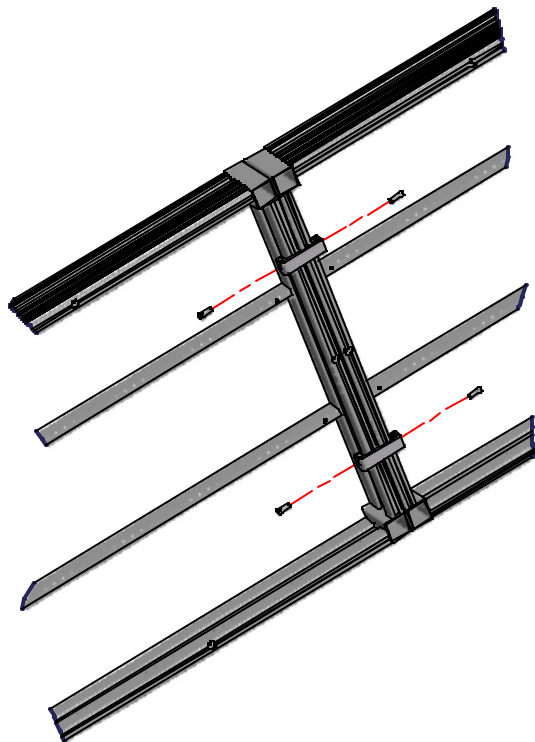

DIAGRAM B

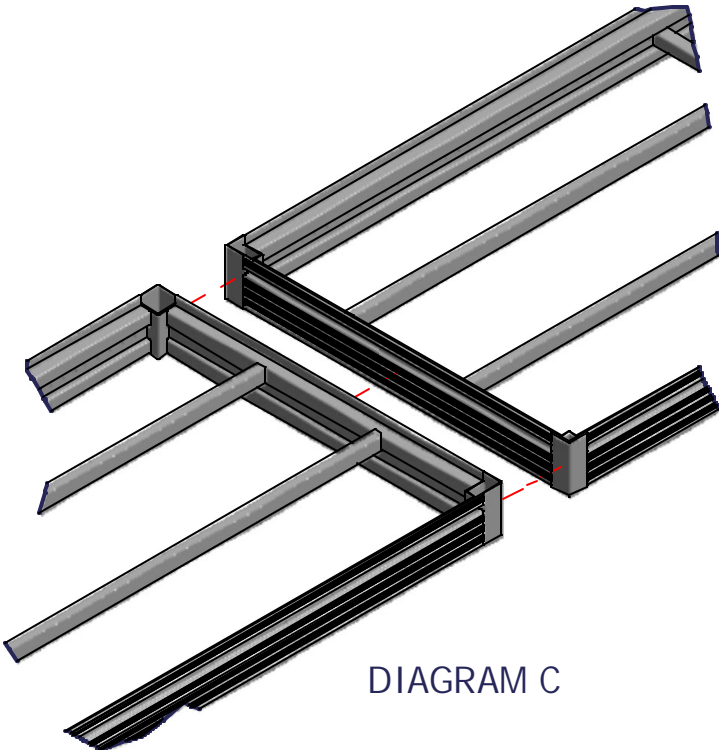
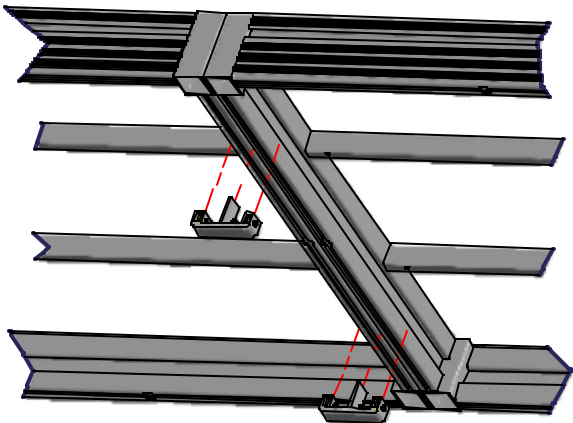

DIAGRAM C

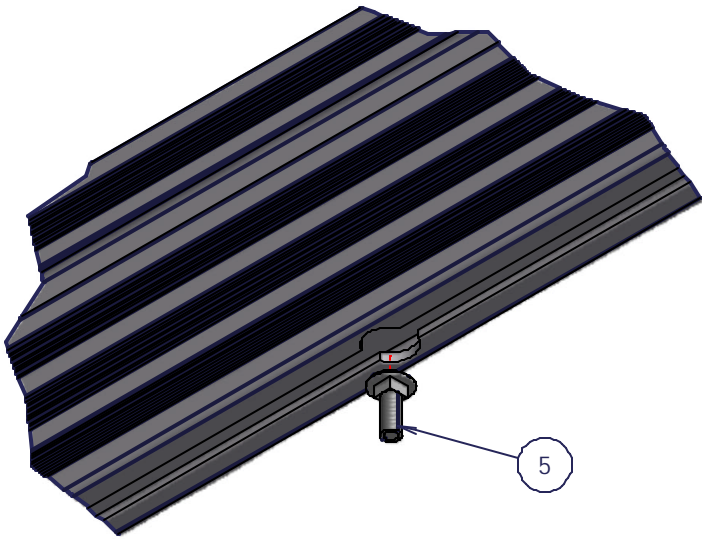

DIAGRAM D

DIAGRAM E

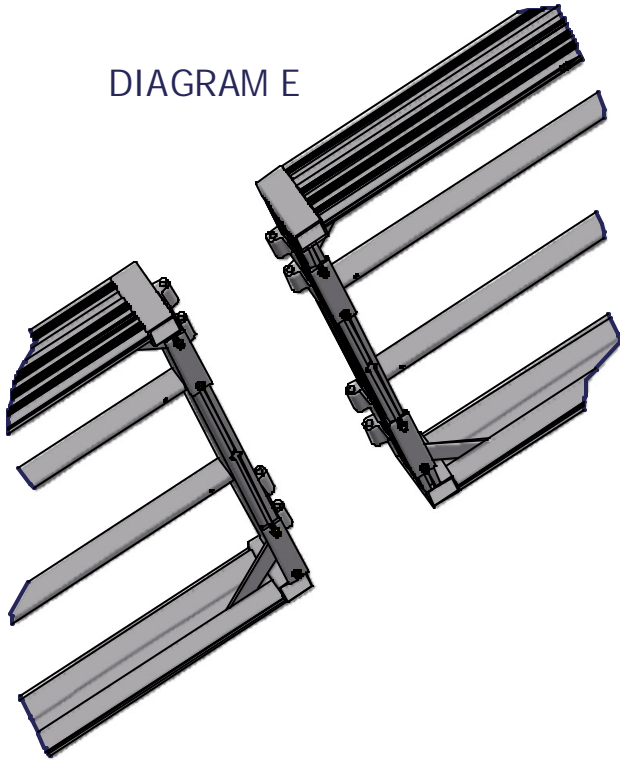

DIAGRAM F

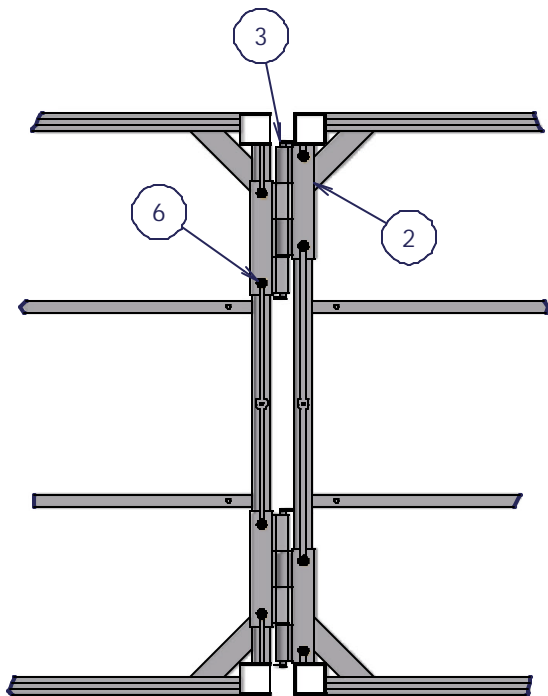
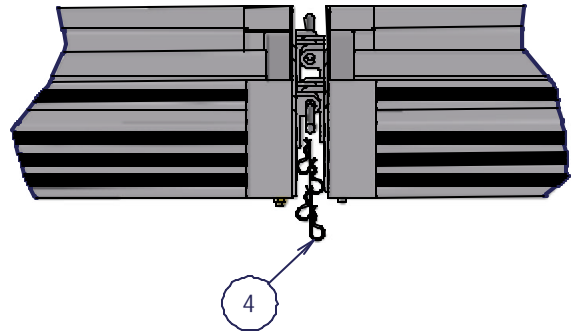

DIAGRAM G

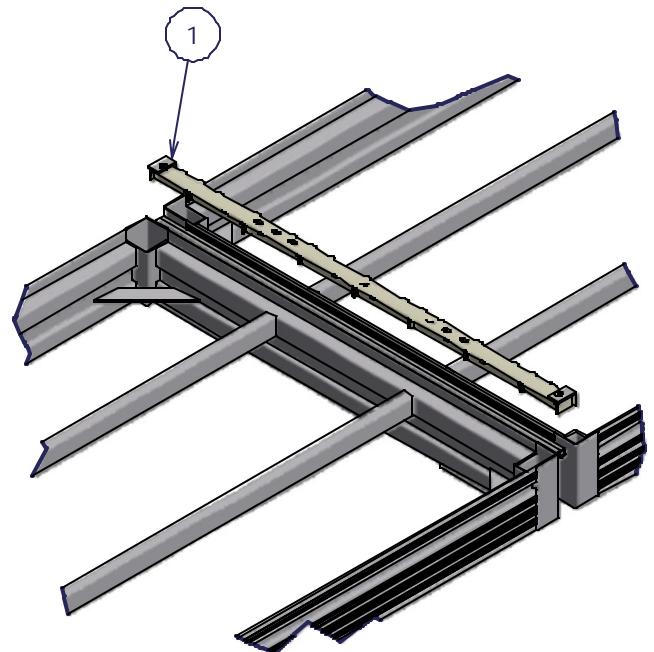

DIAGRAM H