

L	15457	LJW	03-14-12	UPDATED OPTIONS PAGE, UPDATED PRINT DIMENSIONS
K	15424	KMH	12-02-11	53.75 FENDER DIMENSION (E) WAS 66.00"
DWG. REV.	ECR/NDP NUMBER	REVISED BY	DATE	DESCRIPTION

ALL DIMENSIONS ARE IN INCHES
UNLESS OTHERWISE STATED
TOLERANCES EXCEPT AS NOTED

DECIMALS:

.X	±0.100
.XX	±0.060
.XXX	±0.030
.XXXX	±0.010

ANGLES:
±1°

ALL FORMED ANGLES
EQUAL 90° UNLESS
NOTED OTHERWISE

() INDICATES REFERENCE

THE INFORMATION IN THIS DRAWING IS THE SOLE
PROPERTY OF KARAVAN TRAILERS, INC. ANY
REPRODUCTION IN PART OR WHOLE WITHOUT
THE WRITTEN PERMISSION OF KARAVAN TRAILERS,
INC. IS PROHIBITED.

APPROVED BY:

DRAWN BY:
MJ HALFMANN

DATE: 11/08/2007

SHEET: 1 OF 7

SCALE: N/A

KARAVAN TRAILERS	
TITLE:	KDPT-2225-39-SPRING
MAT'L:	SEE B.O.M.
FINISH:	N/A
DWG. #:	KDPT-2225-39-SPRING

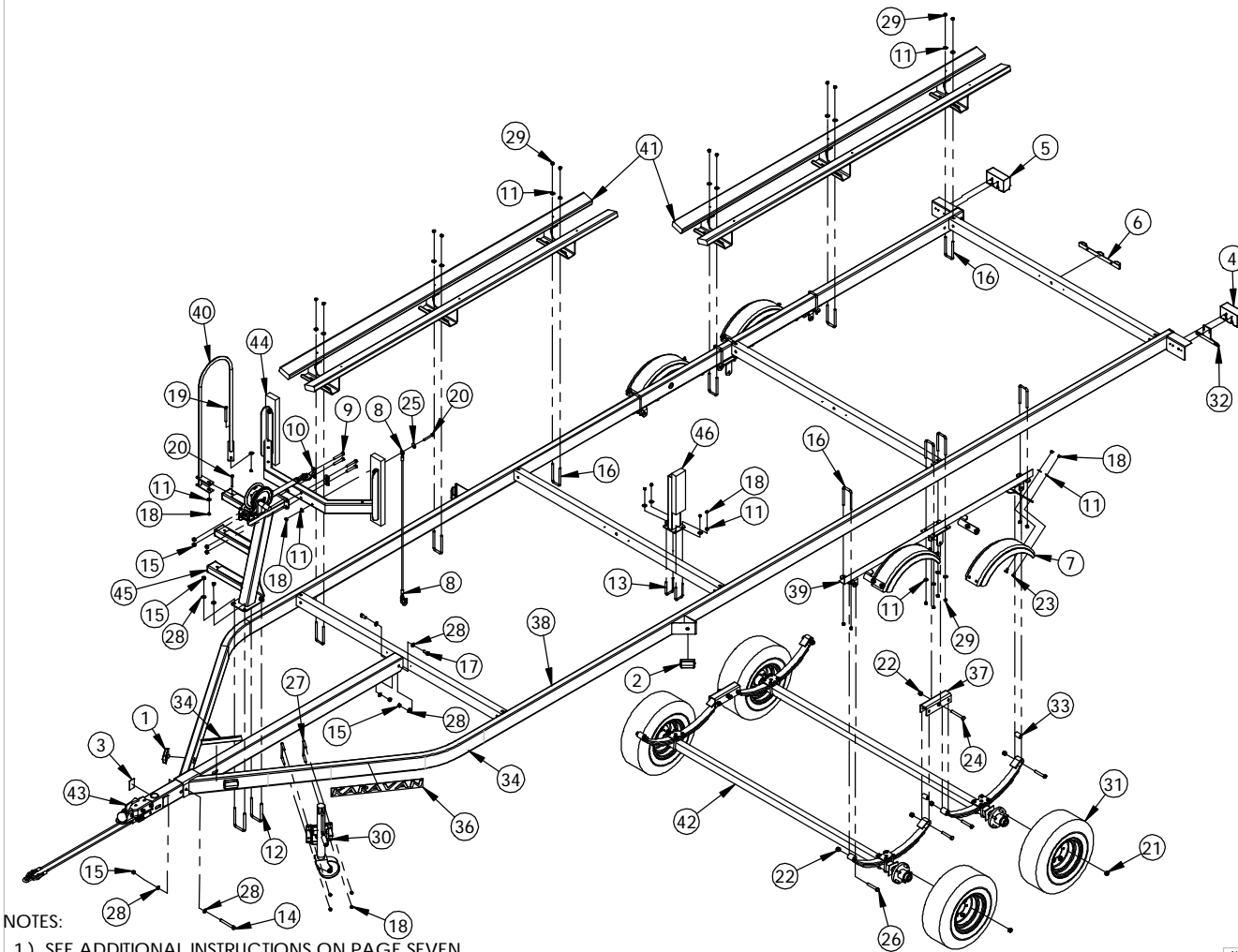

NOTES:

- 1.) SEE ADDITIONAL INSTRUCTIONS ON PAGE SEVEN.
- 2.) SEE ADDITIONAL INSTRUCTIONS ON PAGE FOUR.
- 3.) SEE OPTIONS ON PAGE THREE.
- 4.) AXLES ARE BUILT WITH CAMBER (SPINDLES WILL HAVE A SLIGHT DOWN SLOPE).
- 5.) IF AXLES CAN BE MOUNTED MORE THEN ONE WAY WELD TACKS ON THE ENDS OF AXLE TUBE, INDICATE TOP.

L	15457	LJW	03-14-12	UPDATED OPTIONS PAGE, UPDATED PRINT DIMENSIONS
K	15424	KMH	12-02-11	53.75" FENDER DIMENSION (E) WAS 66.00"
DWG. REV.	ECR/NDR NUMBER	REVISED BY	DATE	DESCRIPTION

ITEM NO.	SEE NOTES	PART NUMBER	DESCRIPTION	QTY.
1	2	205-00105	AMBER SIDE LIGHT	2
2	2	205-00106	AMBER SIDE LIGHT	2
3		205-00142	AMBER REFLECTOR TAPE	2
4	2	205-00157	TAIL LIGHT LH	1
5	2	205-00158	TAIL LIGHT R.H.	1
6	2	205-00163	I.D. BAR LIGHT SUBM.	1
7		206-00039	FENDER	4
8		208-00046	SAFETY CABLE & HOOK	1
9		210-00012	.50"-13 X 3.00" HX HD BOLT	4
10		210-00017	.50" FLAT WASHER	4
11		210-00025	.375" FLAT WASHER	68
12		210-00030	.50"-13 X 3.063" X 5.25" U-BOLT	2
13		210-00031	.375"-16 X 2.031" X 3.75" U-BOLT	8
14		210-00040	.50"-13 X 4.50" HX HD BOLT	1
15		210-00061	.50"-13 CENTERLOCK HEX NUT	11
16		210-00068	.438"-14 X 2.25" X 5.31" U-BOLT	20
17		210-00072	.50"-13 X 1.25" HX HD BOLT	2
18		210-00076	.375"-16 CENTERLOCK HEX NUT	40
19		210-00080	.375"-16 X 4.00" HX HD BOLT	2
20		210-00089	.375"-16 X 3.00" HX HD BOLT	2
21		210-01137	.50"-20 X .813" LUG NUT	20
22		210-01157	.563"-12 NYLOCK HEX NUT	10
23		210-01194	.375"-16 X .875" CARRIAGE BOLT	16
24		210-02205	.563"-12 X 4.00" HX HD BOLT	2
25		210-02207	.375" FLAT WASHER	1
26		210-02211	.563"-12 X 3.25" HX HD BOLT	8
27		210-02231	.375"-16 X 3.00" X 4.06" U-BOLT	2
28		210-02240	.50" SAE FLAT WASHER ZINC	10
29		210-03330	.438"-14 CENTERLOCK HEX NUT	40
30		214-00008	TONGUE JACK	1
31	3	220-00015	5-HOLE TIRE & RIM	4
32		229-00006	LICENSE PLATE BRACKET	1
33		229-00095	BUSHING	4
34		234-00032	TRAILERING CHECKLIST	1
35		234-00058	LOGO	4
36		234-00060	LOGO	2
37		300-00016	EQUALIZER WELDMENT	2
38	3	300-01611	FRAME WELDMENT	1
39		300-01625	SPRING HANGER WELDMENT	2
40		300-01673	HAND RAIL WELD	1
41	1.3	310-01886	BUNK ASSY	4
42	4.5	310-01894	AXLE ASSY	2
43	1.3	310-01915	TONGUE ASSY	1
44		310-02017	WINCH BOARD ASSY	1
45		310-02020	WINCH ASSY	1
46	1.3	310-02292	GUIDE-ON ASSY.	4
47		205-00171	WIRE HARNESS	1
48		205-00171	WIRE HARNESS	-

ALL DIMENSIONS ARE IN INCHES
UNLESS OTHERWISE STATED
TOLERANCES EXCEPT AS NOTED
DECIMALS:
.X ±0.100
.XX ±0.060
.XXX ±0.030
.XXXX ±0.010
ANGLES:
±1°
ALL FORMED ANGLES
EQUAL 90° UNLESS
NOTED OTHERWISE
() INDICATES REFERENCE

THE INFORMATION IN THIS DRAWING IS THE SOLE
PROPERTY OF KARAVAN TRAILERS, INC. ANY
REPRODUCTION IN PART OR WHOLE WITHOUT
THE WRITTEN PERMISSION OF KARAVAN TRAILERS,
INC. IS PROHIBITED.
APPROVED BY: _____
DRAWN BY: *MJ/HALFMANN*
DATE: 11/08/2007
SHEET: 2 OF 7
SCALE: N/A

KARAVAN
TRAILERS

TITLE: KDPT-2225-39-SPRING
MAT'L: SEE B.O.M.
FINISH: N/A
DWG. #: KDPT-2225-39-SPRING

HORIZONTAL GUIDE ON OPTION

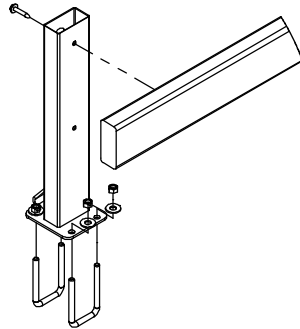

TONGUE TUBE OPTIONS

3" X 5" X 118"
3" X 5" X 142"

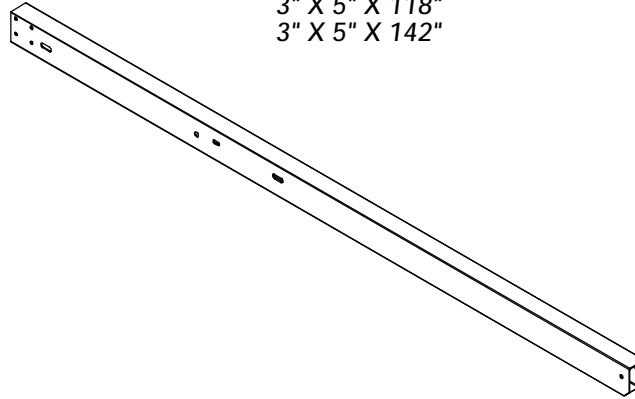

TRI-TOON KIT OPTION

2" X 4" CARPET
2" X 4" PLASTIC
2" X 6" CARPET
2" X 6" PLASTIC

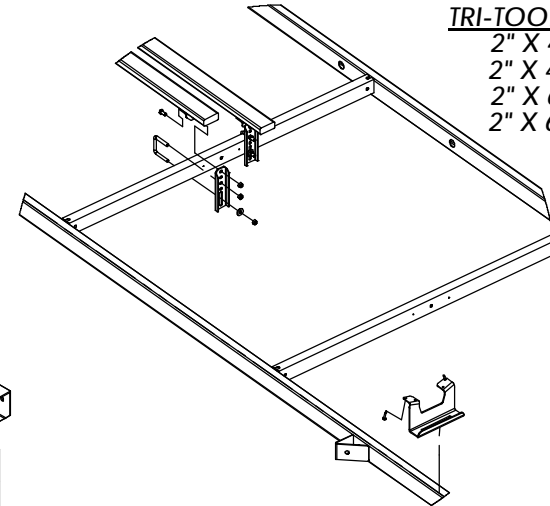

PLASTIC BUNK OPTIONS

2" X 4" X 108" (TWO PER SIDE)
2" X 6" X 108" (TWO PER SIDE)
2" X 6" X 120" (TWO PER SIDE)

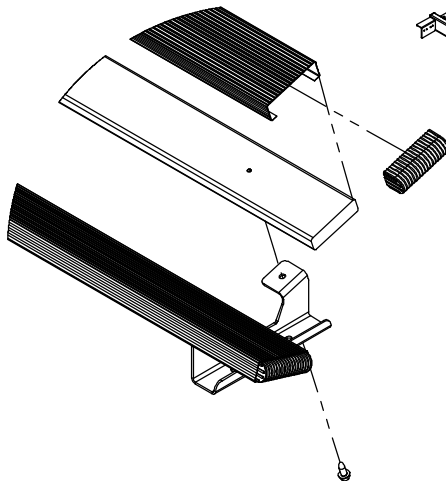

TIRE OPTIONS		
MODEL	KDPT-2225-39	KDPT-2225-39
	20.5 X 8-10E	5.30 X 12D
TIRE	220-00085	220-00060

CARPET BUNK OPTIONS

2" X 6" X 108" (TWO PER SIDE)
2" X 6" X 120" (TWO PER SIDE)

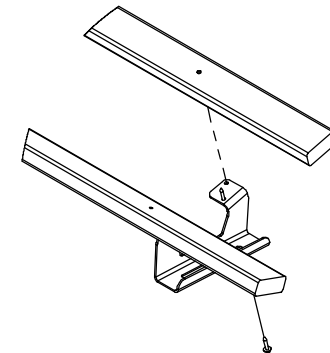

LARGE FRAME OPTION

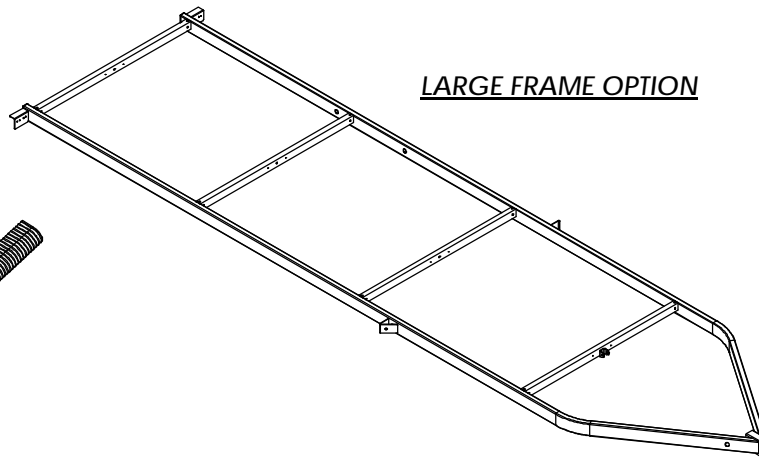

L	15457	LJW	03-14-12	UPDATED OPTIONS PAGE, UPDATED PRINT DIMENSIONS
K	15424	KMH	12-02-11	53.75" FENDER DIMENSION (E) WAS 66.00"
DWG. REV.	ECR/NDP NUMBER	REVISED BY	DATE	DESCRIPTION

ALL DIMENSIONS ARE IN INCHES
UNLESS OTHERWISE STATED
TOLERANCES EXCEPT AS NOTED

DECIMALS:

.X ±0.100
.XX ±0.060
.XXX ±0.030
.XXXX ±0.010

ANGLES:

±1°

ALL FORMED ANGLES
EQUAL 90° UNLESS
NOTED OTHERWISE

() INDICATES REFERENCE

THE INFORMATION IN THIS DRAWING IS THE SOLE
PROPERTY OF KARAVAN TRAILERS, INC. ANY
REPRODUCTION IN PART OR WHOLE WITHOUT
THE WRITTEN PERMISSION OF KARAVAN TRAILERS,
INC. IS PROHIBITED.

APPROVED BY:

DRAWN BY: *MJ HALFMANN*

DATE: 11/08/2007

SHEET: 3 OF 7

SCALE: N/A

KARAVAN
TRAILERS

TITLE: KDPT-2225-39-SPRING

MAT'L: SEE B.O.M.

FINISH: N/A

DWG. #: KDPT-2225-39-SPRING

VIEW A

GREEN & WHITE WIRES RUN
DOWN RIGHT SIDE TUBE.

YELLOW WIRE RUNS
DOWN LEFT SIDE TUBE.

THE TAIL LIGHT IS
MOUNTED TO THE CENTER
HOLES OF THE TAIL
LIGHT BRACKET.

THE TAIL LIGHT IS
MOUNTED TO THE CENTER
HOLES OF THE TAIL
LIGHT BRACKET.

VIEW B

ID BAR WIRE

WIRE HARNESS

L	15457	LJW	03-14-12	UPDATED OPTIONS PAGE, UPDATED PRINT DIMENSIONS
K	15424	KMH	12-02-11	53.75" FENDER DIMENSION (E) WAS 66.00"
DWG. REV.	ECR/NDP NUMBER	REVISED BY	DATE	DESCRIPTION

ALL DIMENSIONS ARE IN INCHES
UNLESS OTHERWISE STATED
TOLERANCES EXCEPT AS NOTED

DECIMALS:

.X ±0.100
XX ±0.060
XXX ±0.030
XXXX ±0.010

ANGLES:

±1°

ALL FORMED ANGLES
EQUAL 90° UNLESS
NOTED OTHERWISE

() INDICATES REFERENCE

THE INFORMATION IN THIS DRAWING IS THE SOLE
PROPERTY OF KARAVAN TRAILERS, INC. ANY
REPRODUCTION IN PART OR WHOLE WITHOUT
THE WRITTEN PERMISSION OF KARAVAN TRAILERS,
INC. IS PROHIBITED.

APPROVED BY:

DRAWN BY:
MJ HALFMANN

DATE: 11/08/2007

SHEET: 4 OF 7

SCALE: N/A

KARAVAN
TRAILERS

TITLE: KDPT-2225-39-SPRING

MAT'L: SEE B.O.M.

FINISH: N/A

DWG. #: KDPT-2225-39-SPRING

MODEL #	DIMENSIONS		
	"D"	"E"	"P"
*	277.1	53.75	48.5

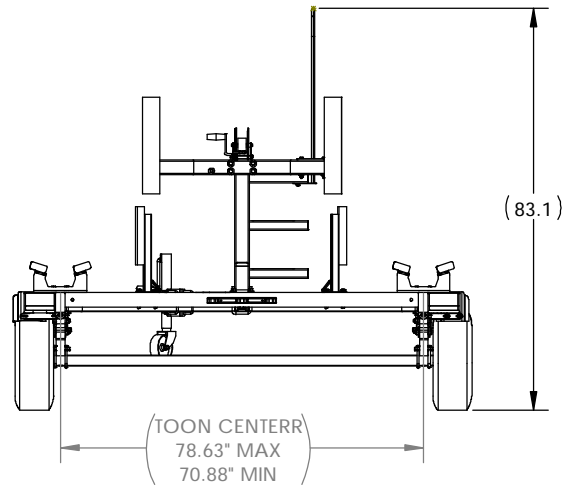
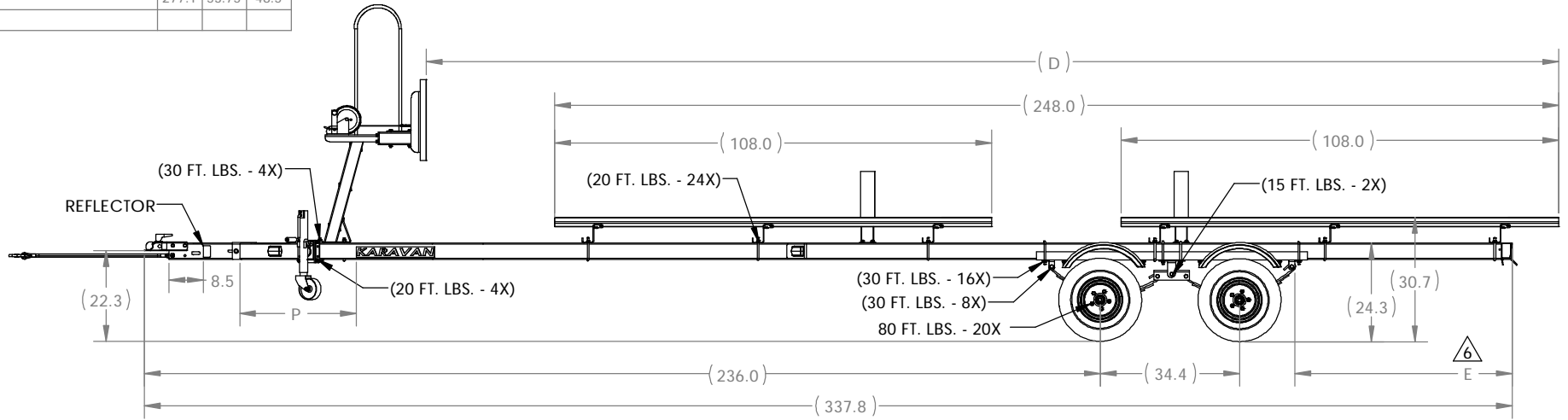

NOTES:

△6 DIMENSION IS FROM THE BACK OF THE SPRING HANGER TO THE BACK OF THE FRAME.

7.) TORQUE CALLOUTS IN PARENTHESIS ARE FOR REFERENCE. TIGHTEN FASTENERS UNTIL PINCHED TIGHT. MINOR DEFLECTION OF MATERIAL IS ACCEPTABLE

DWG. REV.	ECR/NDR NUMBER	REVISED BY	DATE	DESCRIPTION
L	15457	LJW	03-14-12	UPDATED OPTIONS PAGE, UPDATED PRINT DIMENSIONS
K	15424	KMH	12-02-11	53.75 FENDER DIMENSION (E) WAS 66.00"

ALL DIMENSIONS ARE IN INCHES
UNLESS OTHERWISE STATED
TOLERANCES EXCEPT AS NOTED
DECIMALS:
X ±0.100
XX ±0.060
XXX ±0.030
XXXX ±0.010
ANGLES:
±1°
ALL FORMED ANGLES
EQUAL 90° UNLESS
NOTED OTHERWISE
() INDICATES REFERENCE

THE INFORMATION IN THIS DRAWING IS THE SOLE
PROPERTY OF KARAVAN TRAILERS, INC. ANY
REPRODUCTION IN PART OR WHOLE WITHOUT
THE WRITTEN PERMISSION OF KARAVAN TRAILERS,
INC. IS PROHIBITED.
APPROVED BY: ---
DRAWN BY: M. HALFMANN
DATE: 11/08/2007
SHEET: 5 OF 7
SCALE: N/A

KARAVAN
TRAILERS

TITLE: KDPT-2225-39-SPRING

MAT'L: SEE B.O.M.

FINISH: N/A

DWG. #: KDPT-2225-39-SPRING

MODEL #	DIMENSIONS				
	"A"	"B"	"F"	"K"	"L"
*	22.0	18.0	5.5	15.5	32.0

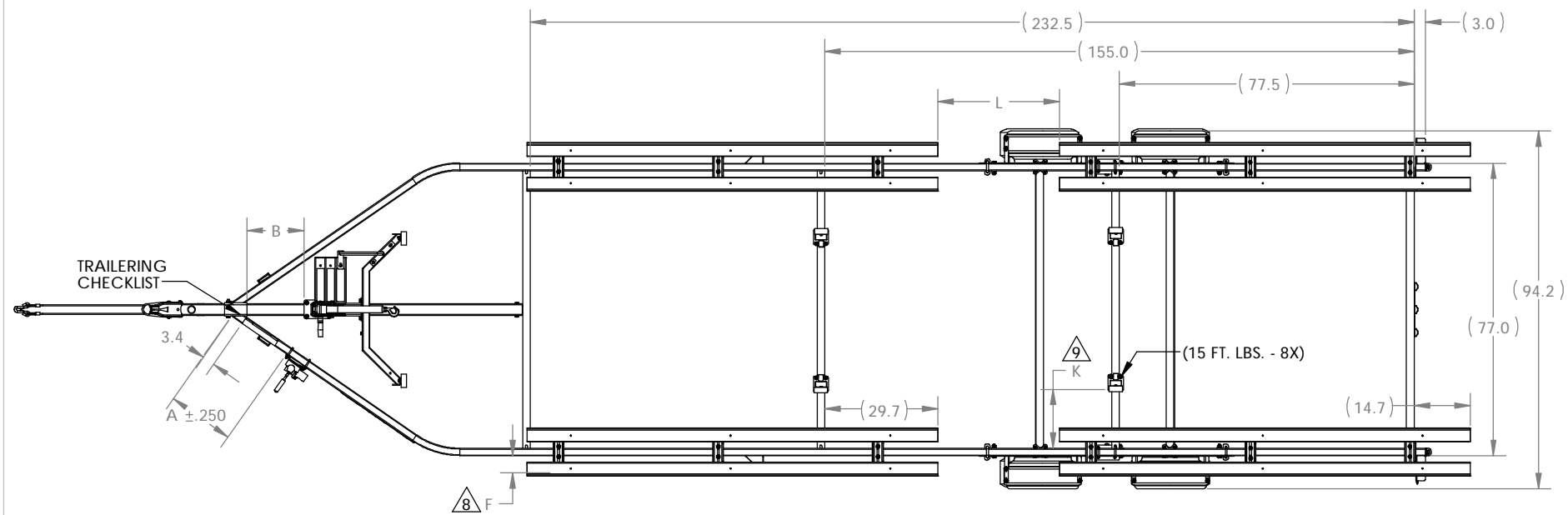

NOTES:

- 8 BUNK LOCATION IS THE DISTANCE FROM THE OUTSIDE OF THE SIDE TUBE TO THE OUTSIDE EDGE OF THE BUNK BRACKET.
- 9 GUIDE-ON LOCATION IS THE DISTANCE FROM THE INSIDE EDGE OF THE SIDE TUBE TO THE OUTSIDE EDGE OF THE GUIDE-ON BRACKET.

L	15457	LJW	03-14-12	UPDATED OPTIONS PAGE, UPDATED PRINT DIMENSIONS
K	15424	KMH	12-02-11	53.75" FENDER DIMENSION (E) WAS 66.00"
DWG. REV.	ECR/NDP NUMBER	REVISED BY	DATE	DESCRIPTION

ALL DIMENSIONS ARE IN INCHES
UNLESS OTHERWISE STATED
TOLERANCES EXCEPT AS NOTED
DECIMALS:
.X ±0.100
.XX ±0.060
.XXX ±0.030
.XXXX ±0.010
ANGLES:
±1°
ALL FORMED ANGLES
EQUAL 90° UNLESS
NOTED OTHERWISE
() INDICATES REFERENCE

THE INFORMATION IN THIS DRAWING IS THE SOLE
PROPERTY OF KARAVAN TRAILERS, INC. ANY
REPRODUCTION IN PART OR WHOLE WITHOUT
THE WRITTEN PERMISSION OF KARAVAN TRAILERS,
INC. IS PROHIBITED.
APPROVED BY:

DRAWN BY:
M J HALFMANN
DATE: 11/08/2007
SHEET: 6 OF 7
SCALE: N/A

KARAVAN
TRAILERS

TITLE: KDPT-2225-39-SPRING

MAT'L: SEE B.O.M.

FINISH: N/A

DWG. #: KDPT-2225-39-SPRING

GUIDE-ON MOUNTING
INSTRUCTIONS

VIEW 1

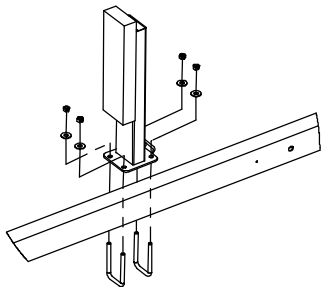

BUNK MOUNTING
INSTRUCTIONS

VIEW 2

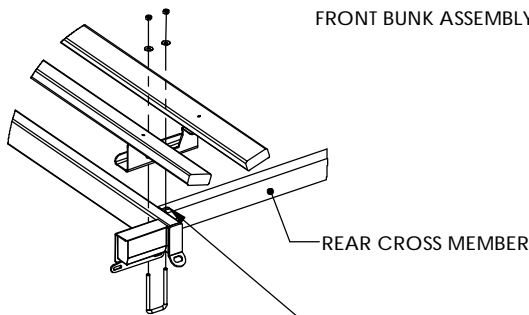

FRONT BUNK ASSEMBLY

REAR CROSS MEMBER

U-BOLT IS MOUNTED THROUGH
THE REAR CROSS MEMBERS

VIEW 3

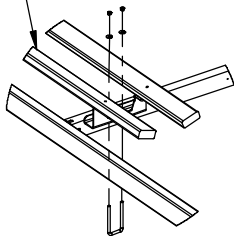

TONGUE MOUNTING
INSTRUCTIONS

VIEW 4

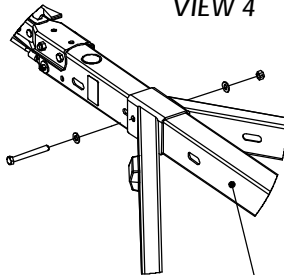

TONGUE TUBE

VIEW 5

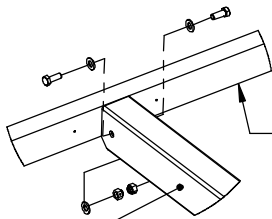

FRONT CROSS
MEMBER

L	15457	LJW	03-14-12	UPDATED OPTIONS PAGE, UPDATED PRINT DIMENSIONS
K	15424	KMH	12-02-11	53.75" FENDER DIMENSION (E) WAS 66.00"
DWG. REV.	ECR/NDP NUMBER	REVISED BY	DATE	DESCRIPTION

ALL DIMENSIONS ARE IN INCHES
UNLESS OTHERWISE STATED
TOLERANCES EXCEPT AS NOTED
DECIMALS:
.X ±0.100
XX ±0.060
XXX ±0.030
XXXX ±0.010
ANGLES:
±1°
ALL FORMED ANGLES
EQUAL 90° UNLESS
NOTED OTHERWISE
() INDICATES REFERENCE

THE INFORMATION IN THIS DRAWING IS THE SOLE
PROPERTY OF KARAVAN TRAILERS, INC. ANY
REPRODUCTION IN PART OR WHOLE WITHOUT
THE WRITTEN PERMISSION OF KARAVAN TRAILERS,
INC. IS PROHIBITED.
APPROVED BY: _____
DRAWN BY: *MJ HALFMANN*
DATE: 11/08/2007
SHEET: 7 OF 7
SCALE: N/A

KARAVAN TRAILERS	
TITLE:	KDPT-2225-39-SPRING
MAT'L:	SEE B.O.M.
FINISH:	N/A
DWG. #:	KDPT-2225-39-SPRING