

### 64940-- 5 Roller Assembly

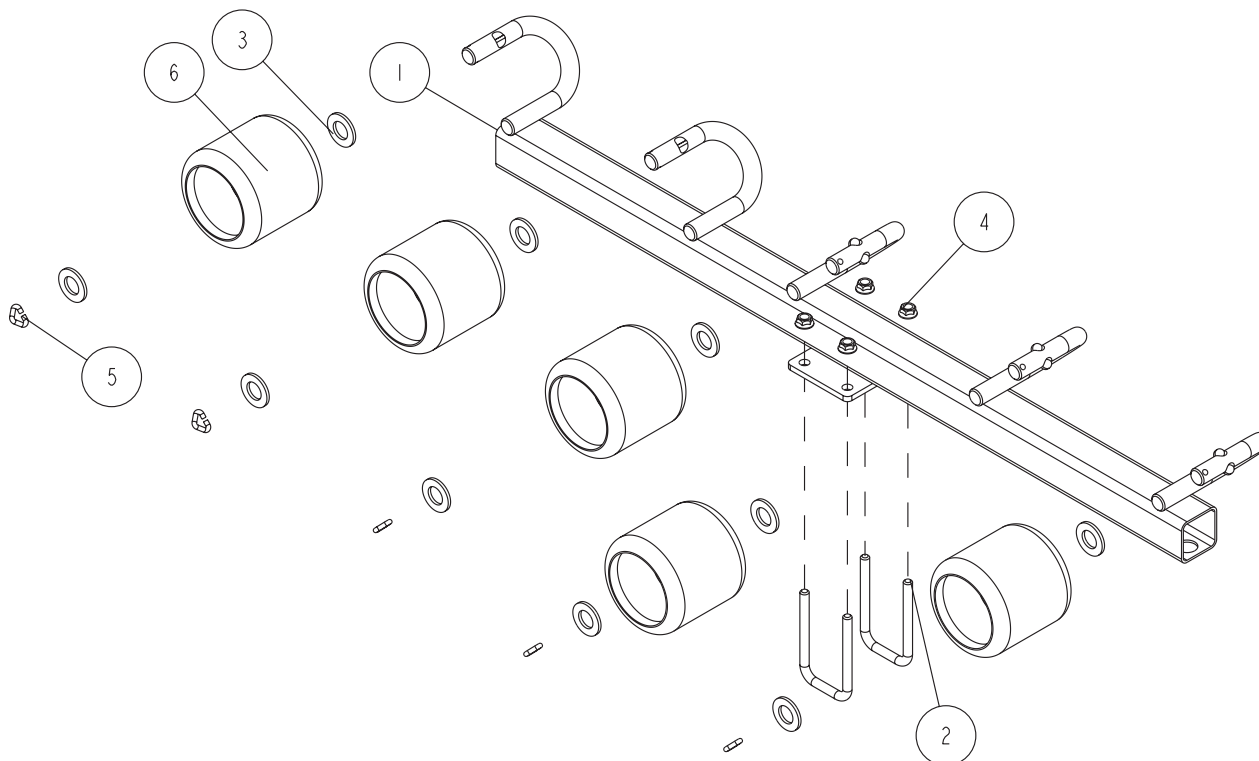

#### BILL OF MATERIALS

ITEM	PART #	DESCRIPTION	QTY
1	64932	5 ROLLER WMENT	1
2	0310103	SUB 3/8 X 2 7/16 X 4	2
3	1310130	WASHER SAE FLAT 3/4	10
4	1440101	FLANGE LOCKNUT SMALL 3/8-16	4
5	1540350	BULL RING PLAIN	5
6	3510036	ROLLER 4IN WOBBLE 3/4IN ID	5

#### Roller Assembly:

Mount the roller assemblies to the rear pivot in a location that best fits your watercraft. Secure with 3/8" X 2-7/16" X 4" square u-bolts and 3/8" X 2-7/16" X 4" square u-bolts and 3/8" flange lock nuts.

#### Roller Adjustment:

Place your boat on the trailer. Determine the spacing on the roller rack. It may be necessary to adjust your roller rack either further in or out from the position you have it assemblies. The boat must be adjusted to miss any keel or strake which might be on your particular boat.

**IMPORTANT:** The roller racks should be spaced as far apart as possible for stability. This in most cases will allow your boat to be as low as possible on the trailer for better trailering, loading and unloading.

Once the roller racks have been spaced properly for your boat, position the boat on the trailer with the transom **flush** with the rear roller rack.